

SYMBOLS

- 208 VOLT OUTLET
- 120 VOLT OUTLET
- DEDICATED CIRCUIT
- JUNCTION BOX
- FLOOR SINK
- FLOOR DRAIN
- FLOOR TROUGH
- WALL DRAIN
- GAS CONNECTION
- COLD WATER
- HOT WATER

EQUIPMENT SCHEDULE

ITEM NO.	QTY	EQUIPMENT CATEGORY	COLD WATER SIZE (N)	COLD WATER AFF (IN)	COLD WATER ACH (IN)	COLD-WATER ROUGH-IN	HOT WATER SIZE (N)	HOT WATER AFF (IN)	HOT WATER ACH (IN)	HOT-WATER ROUGH-IN	DIRECT DRAIN SIZE (N)	DIRECT DRAIN AFF (IN)	DIRECT DRAIN ACH (IN)	DIRECT- DRAIN ROUGH-IN	FLOOR	INDIR DRAIN SIZE (N)	INDIR DRAIN AFF (IN)	INDIR DRAIN ACH (IN)	GAS SIZE (N)	MBTUH	GAS AFF (IN)	GAS ACH (IN)	GAS ROUGH-IN
P103	1	MOP SINK	0.5	24			0.5	24								0.75	1						
P105	1	ICE MAKER W/O BIN	0.5		35	Ø 7/2 AFF	0.5		35	Ø 7/2 AFF					1.5	20							
P122	1	TABLE WORK W/2 COMP SINK	0.5	38		Ø 1 1/2 AFF	0.5	38		Ø 1 1/2 AFF					1.5	20							
P123	3	SINK, HAND, WALL MOUNT	0.5	31.5		Ø 1 1/2 AFF	0.5	31.5		Ø 1 1/2 AFF					1.5	20							
P126	1	BAG-IN-BOX																					
P128	1	DRN. CONNECTION, GAS	0.5	80		Ø 7/2 AFF													0.75	32	43		Ø 8 AFF
P130	1	RANGE, RESTAURANT																	0.75	203	14		Ø 8 AFF
P135	1	RANGE, HEAVY DUTY, GAS																	0.75	120			Ø 8 AFF
P140	1	FRIDGE DEEP FAT, GAS																	0.75	80	30.25		Ø 8 AFF
P141	1	IGROULE, GAS																	0.75	160	30.25		Ø 8 AFF
P144	1	BROILER, UNDER-FREEL, GAS, COUNTER																	0.75	188	30.25		Ø 8 AFF
P148	1	RANGE, RESTAURANT, GAS																					
P182	1	SINK, SOLLERY, 3 COMPARTMENTS (20 X 20 X 12 BOWLS)	0.5	38		Ø 1 1/2 AFF	0.5	38		Ø 1 1/2 AFF					1.5	20							
P187	1	WAREWASHER, DOOR TYPE, LOW TEMP					0.5	31.5		Ø 7/2 AFF					1.5	20							
P170	1	DISHABLE, 1", SHAFR	0.5	39		Ø 1 1/2 AFF	0.5	39		Ø 1 1/2 AFF					2.0								
P173	1	DRCP-IN, WATER STATION	0.375	31.5		Ø 4/4 AFF				Ø 1 1/2 AFF					1.5	30							
P176	1	ICED TEA BREWER	0.25		15	Ø 4/4 AFF									0.75	32							
P179	1	COFFEE MAKER, AIRPOPT, AUTOMATIC	0.5	31.5		Ø 1 1/2 AFF	0.5	31.5		Ø 1 1/2 AFF					1.5	21							
P206	1	UNDERBAR HANDSINK																					
P215	1	UNDERBAR BLENDER STATION	0.5	31.5		Ø 1 1/2 AFF	0.5	31.5		Ø 1 1/2 AFF					1.5	21							
P219	1	UNDERBAR HANDSINK	0.5	31.5		Ø 1 1/2 AFF	0.5	31.5		Ø 1 1/2 AFF					1.5	21							
P221	1	UNDERBAR HANDSINK	0.5	31.5		Ø 1 1/2 AFF	0.5	31.5		Ø 1 1/2 AFF					1.5	21							
P223	1	UNDERBAR BLENDER STATION	0.5	31.5		Ø 1 1/2 AFF	0.5	31.5		Ø 1 1/2 AFF					1.5	21							

ALL DIMENSIONS ARE FOR APPROXIMATE LOCATION INFORMATION ONLY.
 FINAL LOCATIONS MUST BE VERIFIED BY THE TRADES PER
 THE ARCHITECTURAL AND MEP DRAWINGS PRIOR TO ROUGH IN.

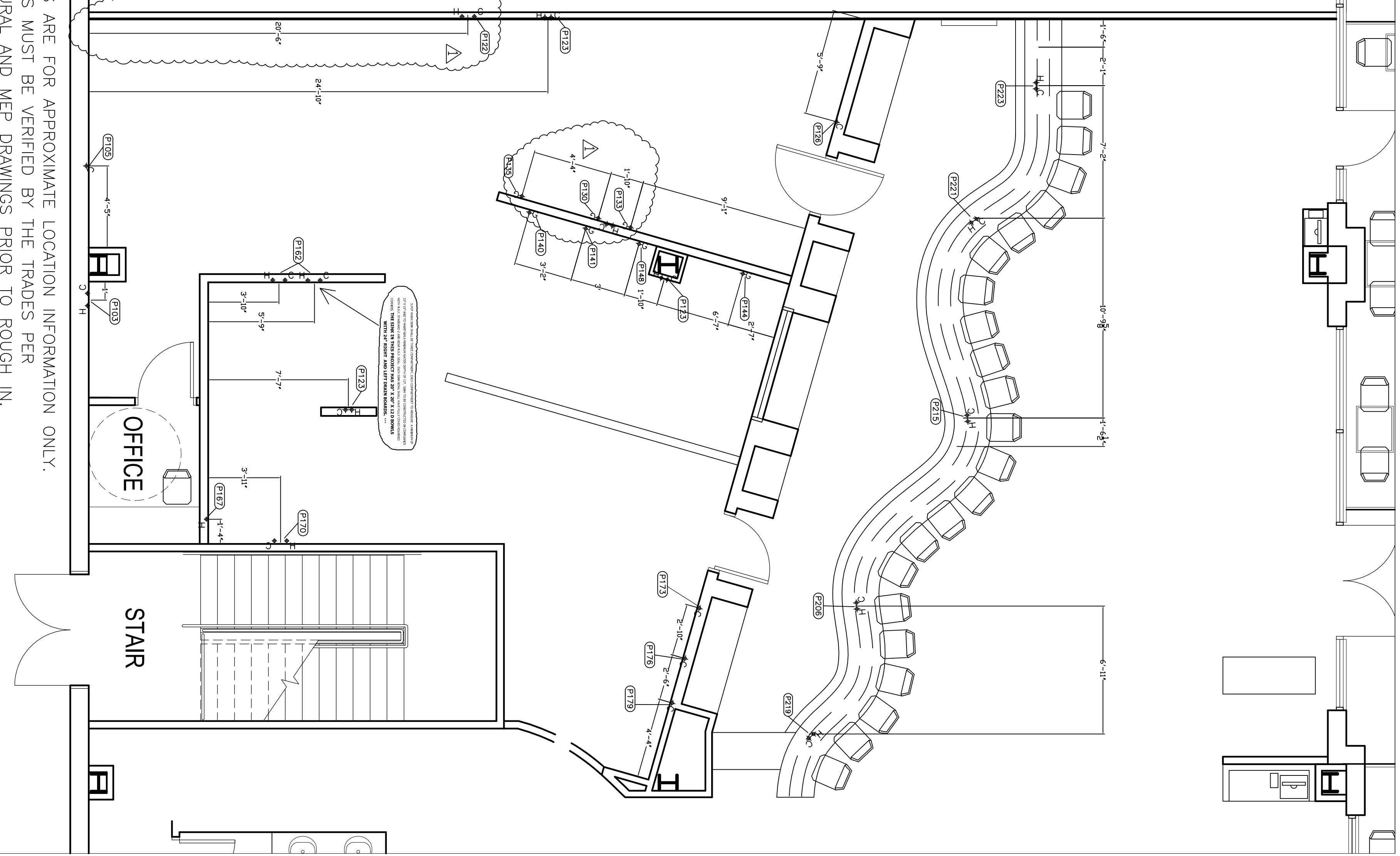

FOR PERMIT	3-31-10	
1 REVISION 1	4-29-10	
NO.	REVISIONS/ISSUES	DATE:

A New Facility For:
TQLA
 4601 WASHINGTON AVE., HOUSTON, TX

Hangman
 PROFESSIONAL KITCHEN OUTFITTERS
 210 Brand Lane • Stafford, TX 77477
 281-495-0999 • Fax 281-495-0102

DESIGNED BY:	WCM
DRAWN BY:	WCM
CHECKED BY:	HMB
SCALE:	1/4" = 1'
SHEET TITLE	PLUMBING RI

SHEET NO.
FS-5