

ROOM NAME

NO.	ROOM NAME
1	DINING AREA
2	WALK-IN COOLER / FREEZER AREA
3	STORAGE AREA
4	BAKING AREA
5	PREPARATION AREA
6	FOOD PRODUCTION AREA
7	DRIVE-THRU AREA
8	WOMEN'S REST ROOM
9	VESTIBULE
10	OFFICE ROOM
11	ORDER AREA
12	PICK-UP & SELF-SERVICE AREA

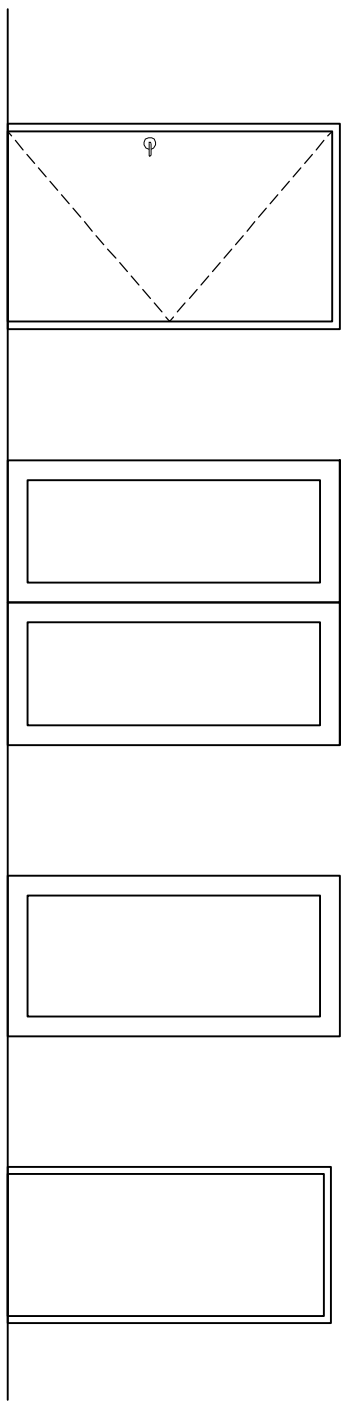

B. DOOR TYPE

DOOR SCHEDULE

NO.	DIMENSION	DOOR MATERIAL	FRAME MATERIAL	FRAMEN TYPE HEAD/JAMB/THRE	FINISHES INSIDE/OUTSIDE	HDWR SET	REMARKS			
①										
②										
③	3'-0"x6'-8"x1 3/4"	S.C. WOOD	HOLLOW MTL.	1	2	3	N/A	N/A	—	REFER TO GENERAL DOOR NOTES
④	4'-0"x6'-8"x1 3/4"	S.C. WOOD	HOLLOW MTL.	1	2	3	N/A	N/A	—	REFER TO GENERAL DOOR NOTES
⑤	3'-0"x6'-8"x1 3/4"	S.C. WOOD	HOLLOW MTL.	1	2	3	N/A	N/A	—	REFER TO GENERAL DOOR NOTES
⑥	3'-0"x6'-8"x1 3/4"	S.C. WOOD	HOLLOW MTL.	1	2	3	N/A	N/A	—	REFER TO GENERAL DOOR NOTES
⑦	3'-0"x6'-8"x1 3/4"	S.C. WOOD	HOLLOW MTL.	1	2	3	N/A	N/A	—	REFER TO GENERAL DOOR NOTES

HARDWARE SCHEDULE

SET A				SET B			
3	HINGES	HAGER	BB1279 4.5X4.5X652XMS	3	HINGES	HINGES	BB1279 4.5X4.5X652XMS
1	PULL	TRIMCO	1013-3X613	1	LOCKSET	FALCON	T521XDANEX626
1	PUSH PLATE	TRIMCO	1013-3X613	1	CLOSER	LGN	P4041XALUMXSNB
1	CLOSER	LGN	P4041XALXSNB	1	KICKPLATE	TRIMCO	8"X34"X626XSMS
2	KICKPLATE	TRIMCO	8"X34"X613XSMS	2	FLOOR STOP	TRIMCO	1211X613
1	FLOOR STOP	TRIMCO	1211X613	1			
1	THRESHOLD	N.G.P.	424 DKB 36"	1			

FLOOR FINISH FF-#

CODE	MATERIAL	MANUFACTURER	SERIES	COLOR	LOCATION	DIMENSIONS	ADDITIONAL INFORMATION
FF-1	VNTL PLANKS	ARMSTRONG	NATURAL CREATIONS MYSIX	PLANK BAMBOO NIGHT BLOSSOM	DINING	4"X36"	
FF-2	VNTL TILE	ARMSTRONG	NATURAL CREATIONS MYSIX	STRAND OAK CHAMPAGNE	DINING	18"X18"	
FF-3	QUARRY TILE	METROPOLITAN	QUARRY BASICS	105 BLACKSKIN	KITCHEN	6"X6"	GROUT: 6-1-3/8" JOINT
FF-4	PORCELAIN TILE	INTERCERAMICS	SLATE	IMPERIAL BLACK	RESTROOMS	12"X12"	GROUT: 6-1-1/8" JOINT
FF-5	VNTL FLOORING	ARMSTRONG	NATURAL CREATION MYSIX	PLANK BAMBOO CITRON	DINING	4"X36"	

BASE B-#

B-1	RUBBER BASE/CODE	ROPPE	700 SERIES RPP	7P100 BLACK	6"X120" ROLL	DINING	SEE DTL 1/A11 PROVIDE PREFORMED INSIDE/OUTSIDE CORNERS
B-2	QUARRY TILE	METROPOLITAN	QUARRY TEXTURES	105 BLACKSKIN	5"X6"	WALL BASE KITCHEN	SEE DTL 3/A11; GROUT: 6-1-3/8" JOINT
B-3	GLAZED TILE	AMERICAN CLEAN	A380	BLACK GLOSS 0049	6"X6"	RESTROOMS	SEE DTL 2/A11; GROUT: 6-2-1/8" JOINT

GROUT G-#

G-1	GROUT (EPOXY)	LATICRETE	SPETRALOCK PRO	22 MIDNIGHT BLACK	FLOORS	
FF-2	ROUT (UNSAVED)	LATICRETE	LATICRETE 1600	22 MIDNIGHT BLACK	WALLS	

PAINT P-#

P-1	PAINT	SHERWIN WILLIAMS	PROCLASSIC & DURATION	WHITE TO MATCH WC-2	DOORS/FRAMES/CELINOS @ KITCHEN	
P-2	PAINT	SHERWIN WILLIAMS	DURATION	SW6109 HOPSACK	WALLS	
P-3	PAINT	SHERWIN WILLIAMS	DURATION	SW6321 RED BAY	WALL & CEILING ACCENTS	
P-4	PAINT	SHERWIN WILLIAMS	DURATION	SW6918 HUMOROUS GREEN	CEILING ACCENTS	
P-5	PAINT	SHERWIN WILLIAMS	DURATION	SW6809 LOBELIA	WALL & CEILING ACCENTS	
P-6	PAINT	SHERWIN WILLIAMS	DURATION	SW6808 CECESTAL	WALLS & CEILING	
P-7	PAINT	SHERWIN WILLIAMS	DURATION	BLACK TO MATCH STOREFRONT	EXPOSED COL. @ STOREFRONT/MISC.	

STAIN S-#

S-1	WOOD STAIN	CUSTOM	T.B.O.	MATCH PL-1	CHAIR RAIL & MISC. TRIM	
-----	------------	--------	--------	------------	-------------------------	--

WALL COVERING WC-#

WC-1	WALL PAPER	MDC WALLCOVERINGS	ANGELA ADAMS	A44603/1120 LULU HONEY	DINING ROOM WAINSCOT	54" WIDE	FURNISHED BY OWNER'S VENDOR, INSTALLED BY G.C.
WC-2	SANITARY WALL	MARLITE	P100-PR	WHITE	KITCHEN/UTILITY ROOM	-	PEBBLE
WC-3	MANUFACTURED STONE	OWENS CORNING-PRO-FIT	EDGE	PLATINUM (PP 8017)	DINING (ACCENT AREAS)		PROVIDE SPECIAL CORNER UNITS.
WC-4	GLAZED CERAMIC TILE	AMERICAN CLEAN	A380	BLACK GLOSS 0049BKMD	RESTROOM WALL	3"X6"	GROUT: 6-2-1/8" JOINT

FLOOR PLAN KEY NOTES:

- PRE-MANUFACTURED MOP SINK – SEE PLUMBING DRAWINGS.
- CABINET/COUNTER – SEE MILLWORK SCHEDULE SHEET A1.0 & MILLWORK SHOP DRAWINGS. PROVIDE BASE **B-1** @ ALL CASEWORK ITEMS (V.I.F.)
- SECURE BASE TILE @ WALK-IN W/ EPOXY ADHESIVE.
- REFER TO DETAIL 3/A1.1 FOR TYPICAL BASE IN KITCHEN AREA & AREAS TO RECEIVE QUARRY TILE BASE. **B-2**
- REFERRED TO DITAIL 2/A1.1 FOR TYP. BASE IN RESTROOM RECEIVING. **B-3**
- REFERRED TO DITAIL 2/A1.1 FOR TYP. BASE IN RESTROOM RECEIVING. **B-3**
- ALIGN FLOOR FINISH TRANSITION W/ FINISHED FACED OF ANGLED WALL.
- REFER ALSO TO FLOOR PLAN, SHEET A2.0 FOR MATCHING RADIUS POINT AND RELATED DIMENSIONS.

GENERAL FLOOR FINISH NOTES

- REFER TO PLUMBING PLANS FOR FLOOR DRAIN, FLOOR SINK, HUB DRAIN & CLEANOUT LOCATIONS. COORDINATE TILE INSTALLATION AROUND THESE ITEMS AND W/ PLUMBING CONTRACTOR TO ACHIEVE A CLEAN, FLUSH INSTALLATION.
- BASE NOT REQUIRED @ STOREFRONTS EXTENDING TO FLOOR.
- REFER ALSO TO INTERIOR ELEVATIONS ON SHEETS A3.0 A3.1 FOR EXTEND OF BASE @ WALL FINISHES.

GENERAL DOOR NOTES:

- ALL HARDWARE SHALL BE FURNISHED AND INSTALLED BY THE GENERAL CONTRACTOR UNLESS NOTED OTHERWISE.
- SEE HARDWARE SETS FOR REQ'D. FINISHES.
- ALL DOORS TO BE KEYED ALIKE TO MASTER BLDG. SYSTEM AS APPLICABLE.
- HOLLOW METAL FRAMES SHALL BE 16 GA. STEEL.
- ALL DOORS SHALL HAVE ADA APPROVED TYPE HARDWARE (VERIFY IN FIELD).
- EXISTING EXIT HARDWARE SHALL COMPLY WITH ALL APPLICABLE CODES. (V.I.F.)
- THE MAXIMUM DIMENSION FROM THE TOP OF THE THRESHOLD TO THE EXTERIOR LANDING @ EXISTING 2" DOORS SHALL NOT EXCEED 17/2". (VERIFY IN FIELD).
- ALL GLAZING IN DOORS AND WITHIN A 24" ARC OF THE SIDES OF AN EGRESS DOORS SHALL BE OF AN APPROVED SAFETY TYPE. (VERIFY IN FIELD).
- PAINT HOLLOW METAL FRAMES & FINISH COATS OF HIGH-GLOSS ACRYLIC ENAMEL. SEE ELEVATIONS & FINISH SCHEDULE.
- PROVIDE SIGNS @ EXISTING DINING ROOM DOORS TO READ, "THIS EXIT MUST REMAIN UNLOCKED WHEN THIS BUILDING IS OCCUPIED. LETTERS SHALL BE 1" TALL & MOUNTED ON A CONTRASTING BACKGROUND.
- ADJUST CLOSERS @ EXISTING DINING ROOM DOORS SUCH THAT SWEEP PERIOD FROM AN OPEN POSITION OF 70 DEGREES. THE DOORS SHALL TAKE AT LEAST 3 SECONDS TO MOVE TO A POINT 3" FROM THE LATCH, MEASURED TO HE LEADING EDGE OF DOOR. MAXIMUM OPENING FORCE OF DOORS SHALL BE 5 LBF.
- DOOR DETAILS DO NOT DEPICT ALL INTERIOR FINISHES. REFER TO INTERIOR ELEVATIONS & FINISH MATERIAL SCHEDULE FOR REQ'D FINISHES.

SYMBOL KEYS:

- FLOOR DRAIN
- PUNNER FLOOR DRAIN
- FLOOR SINK

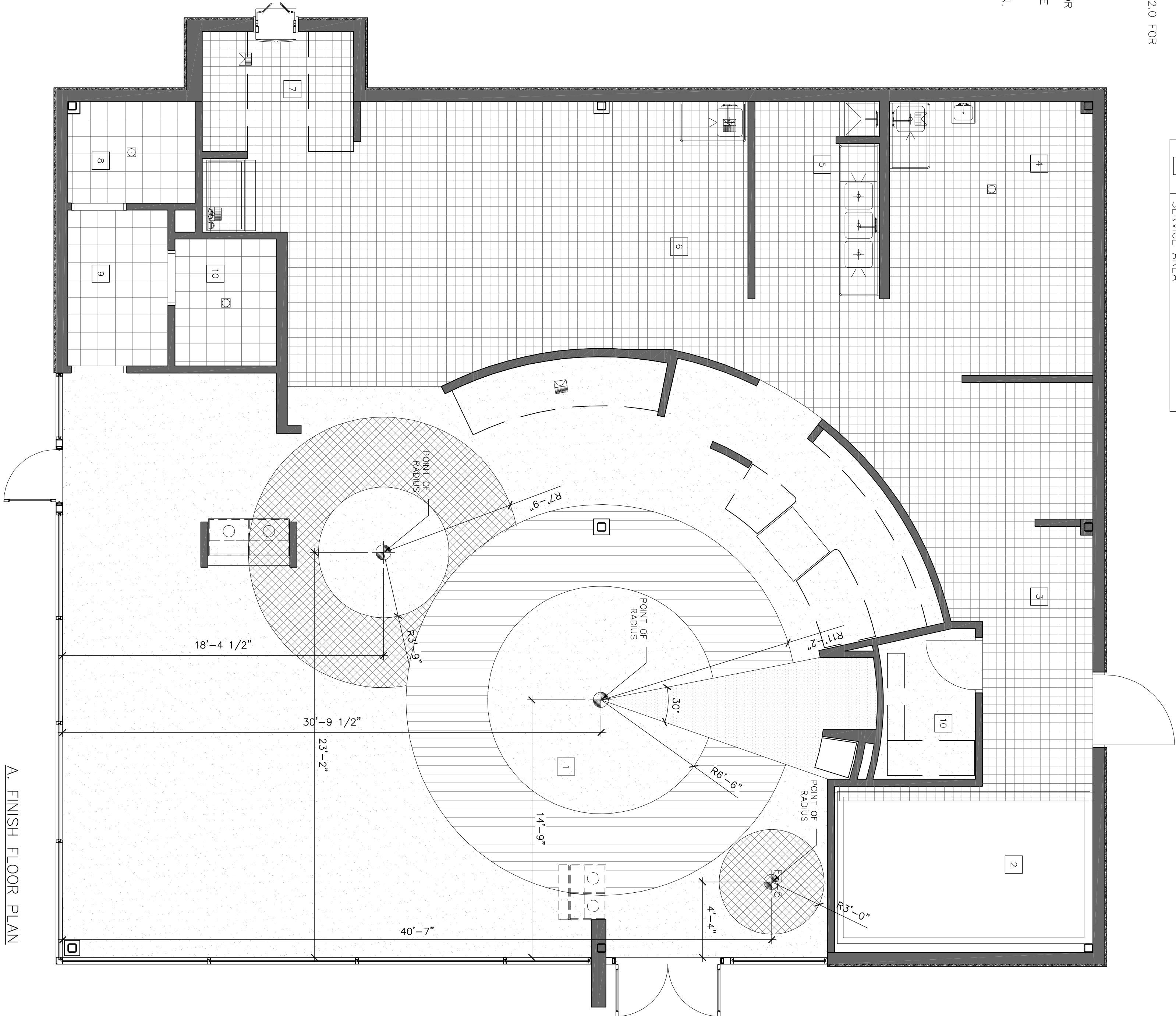

A. FINISH FLOOR PLAN

SCALE - 1/4" = 1'-0"
AREA: 3,000 SQ.FT.

Rev.	By	Date

SCHLOTZSKY'S
@ VICTORY LAKETOWN CENTER
TRACT 7A NEC INTERSTATE HWY 45 & F.M.646
LEAGUE CITY, TEXAS 77573

ARCH
WOO Associates, LLC.
ARCHITECTS – PLANNERS
13734 Briarwood Green Dr.
Houston, TX 77083
(281) 530-3192

Date	05-26-2010
Scale	AS SHOWN
Drawn by	KW
Job#	VICTORY LAKE

A2.1