

NOTES TO SHEET A1-1

1. 1/2" STEEL PLATE WELDED AND GROUND SMOOTH PRIOR TO GALVANIZING. SLOPE 1/8" FOR WATER DRAINAGE - PAINT.
2. 1'-0"x1'-6"x90 800 ALUMINUM HANDICAPPED PARKING SIGN TO READ "RESERVED PARKING" WITH IDENTIFICATION SYMBOL. BOLTED TO STEEL TUBE WITH 3/8" CADMIUM PLATED BOLTS, NUTS AND WASHERS. RE: 2/A1.1
3. PROVIDE VAN ACCESSIBLE SIGN WHERE NOTED ON PLANS.
4. 12"x2"x0.1875" GALV. STEEL TUBING. EXTEND INTO TOP OF GRADE.
5. TOP OF GRADE. CONCRETE FOOTINGS, SAND SMOOTH, PRIME AND PAINT.
6. 3000 PSI CONCRETE FOOTING.
7. ALLOW 4" MIN. AROUND STEEL TUBE AT ALL FOUR SIDES.
8. INTERNATIONAL SYMBOL OF ACCESSIBILITY. CENTER WITHIN SPACE. BLUE FIGURAR WITH BLUE SHALL BE EQUAL TO COLOR NO. 15090 IN FEDERAL STANDARD 595A.
9. 4" WIDE PAINTED STRIPE - WHITE.
10. PAINT CONCRETE BASE TO MATCH STRIPING.
11. LIGHT POLE. RE: ELECTRICAL DRAWINGS.
12. CONDUITS SHALL BE 1/2" DIA. GALV. STEEL. PAINTED AND GROUND SMOOTH.
13. REINFORCE CMU WALL W/ #5 VERTICAL @ 24" O.C. - FILL WALL CELLS W/ MORTAR AT VERTICAL REINFORCING- DOWEL VERTICAL REINFORCING TO GRADE BEAM.
14. ELECTRICAL CONDUIT.
15. 3000 PSI CONCRETE CURB.
16. (6) #7 VERTICALS WITH #3 TIES AT 12" O.C. (3) #3 TIES @ 12" O.C.
17. PROVIDE HEAVY DUTY ANCHOR BOLTS - SIZE AND LENGTH AS REQUIRED BY THE POLE MANUFACTURER.
18. BOLARDS PER POWER COMPANY REQUIREMENTS.
19. BOND BEAM. W/1-#5 CONTINUOUS.
20. MORTAR WASH.
21. TOP OF PAVING.
22. SEALANT.
23. DUMPSTER ENCLOSURE IS ISOLATED PRICE "A"
24. GALV. STEEL PLATE CENTERED IN DOOR PANEL.
25. PAINTED 1/2" DIA X 6" LONG PULL WELD VERTICALLY TO FRAME WITH CENTER OF PULL AT 54" ABOVE PAVING.
26. HEAVY DUTY BALL BEARING HINGE WITH PAINTED FINISH (3 PER LEAF)
27. 1/2" X 1/8" ANCHOR BAR-MINIMUM 2 PER WHEELSTOP.
28. PAINT 1/2" DIA. GALV. METAL DECK-TYPE BALL STRIPING @ 24" O.C. ACCESSIBLE AT 11" TO 14" ABOVE PAVING.
29. CONCRETE AT 11" SPACES SEE 7/A1.1 FOR LOCATIONS.
30. PAINTED 6" DIA. GALV. STEEL BOLLARD FILL WITH CONCRETE (GROWN ON TOP). PAINT FINISH. RE: 6/A1.2
31. TRANSFORMER. RE: ELECT. DWGS.
32. STANDARD PRE-CAST 6'-0" CONCRETE WHEELSTOP.
33. RE: 4/A1.2
33. PAINTED 8"x8"x16" CMU WALL DUMPSTER ENCLOSURE.
34. PAINTED 6"x6"x4" GALV. STEEL TUBE FILLED WITH CONCRETE AND CROWNED AT TOP. TOP TO BE AT 6'-0" ABOVE GRADE.
35. TYPICAL SLAB : 6" THICK CONC. SLAB ON FILL REINFORCED W/ #4 @ 12" O.C. EW (MID)
36. PAINTED 4"x3"x4" GALV. STEEL ANGLE FRAME CONT. AT GATE LEAF PERIMETER. MITER CORNERS. GRIND SMOOTH, PRIME AND PAINT.
37. GATE. RE: 13/4&15/A1.2
38. PROVIDE 3/4" DIA. (24") LONG CANE BOLT EACH LEAF.
39. STOP SIGN. RE: 17/A1.1
40. DIRECTIONAL ARROWS. PAINT IN WHITE BY SITE LETTER CONTRACTOR. RE: 14/A1.1
41. MOUNT WHITE PAINTED LETTERS FOR "STOP".
42. 2" WIDE WHITE PAINTED STRIPE BY SITE LETTER CONTRACTOR.

THE PRESENCE OF ENGINEER SEAL ON THIS DOCUMENT APPLIES TO STRUCTURAL RELATED ITEMS ONLY AND DOES NOT IMPLY THIS CONSULTANT'S PRACTICE OF ARCHITECTURE.

DEVELOPMENTAL SYNOPSIS

LAND AREA (TRACT 7):	0.7634 ACRE (33,255 SQ.FT.)
RETAIL FLOOR AREA:	3,000 SQ.FT.
TOTAL PROVIDED PARKING SPACE:	34
REGULAR PARKING SPACES:	34
ACCESSIBLE PARKING SPACES:	2
PARKING RATIO(RECD):	RETAIL 1/250 SQ.FT. TOTAL 12
PARKING PROVIDED:	TOTAL 36

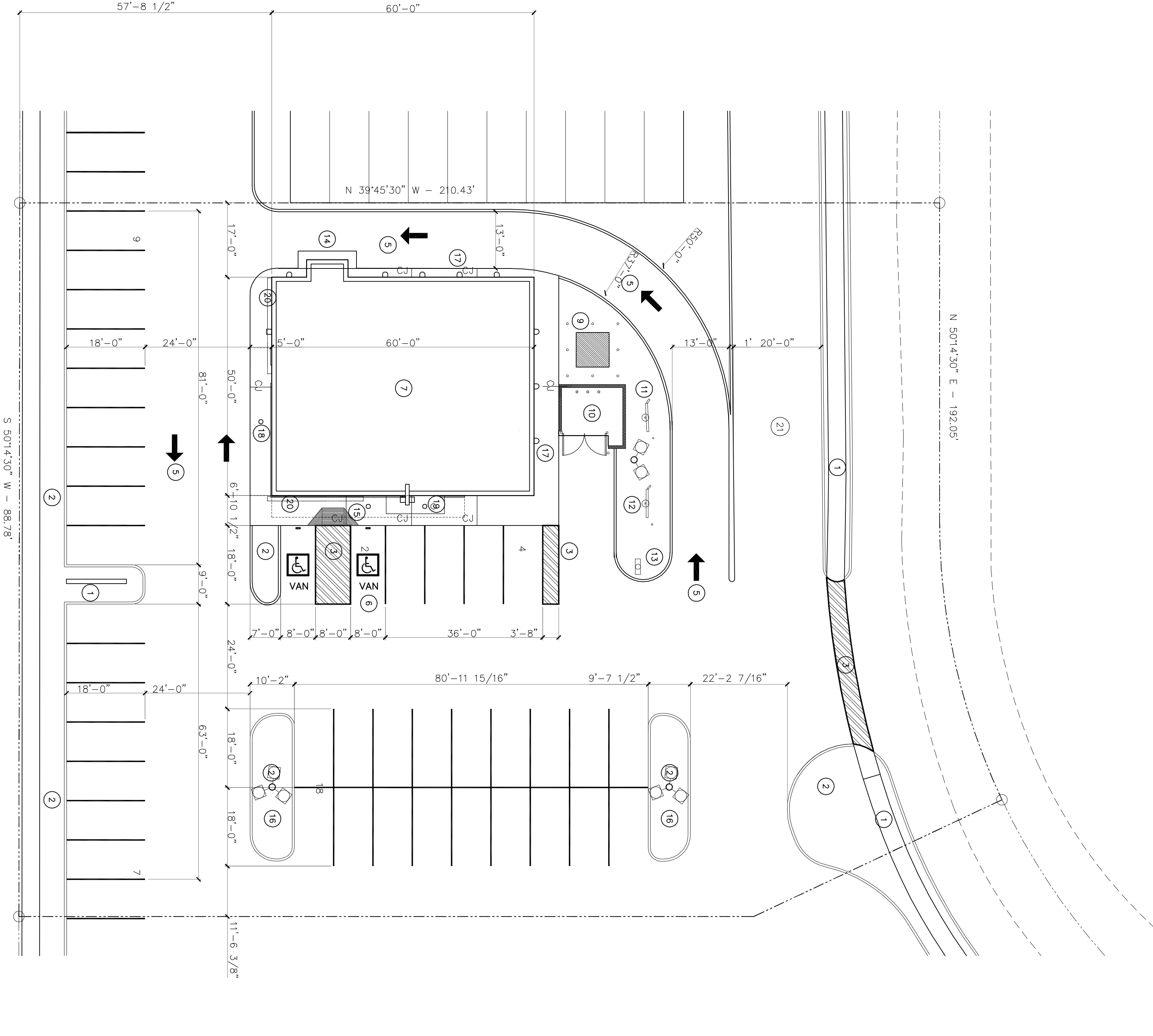

F.M. 646

A. SITE PLAN  
SCALE: 1/16" = 1'-0"  
AREA: 7,000 SQ.FT.

- SITE LEGEND
- 1 SIGNAGE BY SCHLOTZSKY'S
  - 2 PLANTER / LANDSCAPE
  - 3 ACCESSIBLE PARKING AISLE W/4" STRIPS AT 2'-0" O.C. AT 45° TO PARKING STRIPE. WHITE. RE: A0-2
  - 4 SEE 19/A1.1 ENTRY DRIVE DETAIL
  - 5 SEE 14/A1.1 DIRECTIONAL ARROW
  - 6 SEE 1/A1.1 ACCESSIBLE PARKIN
  - 7 BUILDING OUTLINE
  - 8 SIDEWALK. REFER CIVIL DRAWINGS
  - 9 TRANSFORMER (IF REQ'D). REFER 7/A1.1
  - 10 DUMPSTER. REFER 7/A1.1
  - 11 ORDER STATION BY SCHLOTZSKY'S
  - 12 MAUV BOARD BY SCHLOTZSKY'S
  - 13 ADVERTISEMENT SIGN BY SCHLOTZSKY'S
  - 14 DRIVE THRU WINDOW
  - 15 ACCESSIBLE RAMP DETAIL. REFER 20/A1.1
  - 16 LIGHT POLE. REFER A1.1
  - 17 WALL LIGHT
  - 18 CANOPY SOFFIT LIGHT
  - 19 PENDANT LIGHT
  - 20 ILLUMINATED WALL SIGN
  - 21 PROPOSED TRUCK ROUTE

ACHTIECTURAL SITE PLAN NOTES

- CONSTRUCTION OF ALL ADJEWAY IN STREET RIGHT-OF-WAY SHAL BE IN CONFORMANCE WITH THE LATEST EDITIONS OF THE TEXAS BUILDING SAFETY SPECIFICATIONS, CITY OF LEAGUE CITY, OR TEXAS HIGHWAY DEPARTMENT STANDARDS AS APPLICABLE.
- SPECIAL CARE SHALL BE TAKEN WITH NEW CONSTRUCTION ALONG ADJACENT PROPERTY LINES. ADJACENT PROPERTY SHALL BE ALTERED ONLY AS SPECIFICALLY REQUIRED IN THESE DRAWINGS AND BY THE CONTRACTOR IF ANY DAMAGE OCCURS.
- REFER TO CIVIL, PLUMBING, AND ELECTRICAL DRAWINGS FOR ALL UTILITY SERVICES TO AND ON THE SITE.
- REPAIR ALL LANDSCAPING AND GLASS AREAS DAMAGED BY CONSTRUCTION. BACKFILL WITH TOP SOIL AND GRASS PER LANDSCAPE SPECIFICATIONS.
- HANDICAP PARKING SPACES AS SHOWN ON THE SITE PLAN SHALL BE DESIGNATED BY ABOVE GRADE SIGN AT EACH SPACE PER STATE AND LOCAL APPLICABLE CODES AND STANDARDS. MANEUVERING SPACE BETWEEN EACH SHALL HAVE 4" WIDE PAINTED WHITE STRIPES AT 12" O.C. PROVIDE CONCRETE RAMPS AT WALKS AS DESIGNATED ON PLANS.
- ACCESSIBLE RAMPS SHALL SLOPE AT 1:12. MAXIMUM REFER TO PLANS. SCORE RAMP SURFACE AT 3" O.C. ACCESSIBLE AND DELIVERY RAMPS SHALL HAVE A NON-SKID FINISH.
- CONTRACTOR SHALL NOT RESTRICT ACCESS TO ADJACENT BUILDINGS, SITES OR ROADWAYS.
- IRRIGATION SLEEVES SHALL BE SET 24" BELOW GRADE AT PAVED DRIVE OR SIDEWALK AREAS. CONTRACTOR SHALL PROVIDE IRON PINS AT EACH END TO MARK LOCATIONS. SEE ALSO LANDSCAPE DRAWINGS FOR ADDITIONAL INFORMATION.
- PIPES INDICATED AS TELE PIGAGE FOR FUTURE USE AND SHALL BE STUBBED UP TO 4" TO 6" ABOVE FINISH GRADE AND CHARGED SCHED 40 END WITH AN IRON PIN. ALL ELEC PWC SLEEVES SHALL HAVE PULL WIRES INSTALLED.
- SIDEWALKS SHALL BE MIN. 4" INCH THICK WITH 6X6 W2.9W2.9 WELDED WIRE FABRIC CENTERED IN THE SLAB. TYPICAL.
- THE CONTRACTOR SHALL CONFORM TO AND ADHERE TO THE REQUIREMENTS IN THE CIVIL DRAWINGS RELATED TO THE POLLUTION PROTECTION PLAN" AND THE EPA'S NATIONAL POLLUTANT DISCHARGE ELIMINATION SYSTEM.
- CONTRACTOR SHALL OBTAIN AND PAY FOR ALL PERMITS NECESSARY TO PERFORM DEMOLITION WORK WITHIN THE PROPERTY LINE AND IN THE STREET RIGHT-OF-WAY.
- THE CONTRACTOR SHALL COORDINATE WITH THE LOCAL UTILITY COMPANIES FOR THE DISCONNECTION AND PLUGGING OF ALL PUBLIC UTILITIES SERVING STRUCTURES WHICH ARE TO BE DEMOLISHED.
- CONTRACTOR SHALL ARRANGE AND PAY FOR RELOCATION OF POWER POLES AND UTILITIES REQUIRING DEMOLITION IN ORDER TO PERFORM NEW CONSTRUCTION.
- THE CONTRACTOR SHALL PROVIDE AND MAINTAIN ALL SIGNS AND BARRICADES AND TRAFFIC CONTROL AS REQUIRED BY SAFETY TO ALL PEDESTRIAN VEHICLES AND SURROUNDING BUILDING AND UTILITIES THROUGH ALL PHASE OF THE CONSTRUCTION.
- ANY DAMAGE TO EXISTING SITE IMPROVEMENTS OR SURROUNDING IMPROVEMENTS, PUBLIC OR PRIVATE, BY THE CONTRACTOR SHALL BE REPAIRED OR REPLACED AS APPLICABLE.
- OPEN TRENCHES AT PERIMETER OR EXISTING PAVING OR AROUND NEW CONSTRUCTION SHALL BE PUMPED FREE OF STANDING WATER AT ALL TIMES. SEE CIVIL DRAWINGS AND SPECIFICATIONS FOR TRENCH SHORING REQUIREMENTS AS APPLICABLE.
- WHERE EXISTING CONCRETE CURB IS TO BE REMOVED AS INDICATED OF THIS PLAN AND CIVIL DRAWINGS, SAW CUT EXISTING CURB 1-1/2" INCHES DEEP MIN. AND REMOVE TWO FEET OF EXISTING PAVING FOR NEW CONSTRUCTION.
- UNLESS OTHERWISE NOTED ALL PRIMER TER LANDSCAPING ABOUTING CURBS SHALL BE FINE GRADED TO TOP OF CURB. PROVIDE FERTILE, FRIABLE, SANDY LOAM FILL TO TOP OF CONCRETE CURB AT ALL AREAS DESIGNATED AS LANDSCAPE AREAS. SEE ALSO LANDSCAPE DRAWINGS.

SCHLOTZSKY'S  
@ VICTORY LAKETOWN CENTER  
TRACT 7A NEC INTERSTATE HWY 45 & F.M.646  
LEAGUE CITY, TEXAS 77573

Rev.	By	Date

**ARCH**  
WOO Associates, LLC.  
ARCHITECTS - PLANNERS  
13734 Briarwood Green Dr.  
Houston, TX 77083  
(281) 530-5192

Date	05-26-2010
Scale	AS SHOWN
Drawn by	KW
Job #	VICTORY LAKE

A1.0