

FLOOR PLAN KEY NOTES:

- ① PRE-MANUFACTURED KOP SINK - SEE PLUMBING DRAWINGS.
- ② CABINET/COUNTER - SEE MILLWORK SCHEDULE SHEET A1.0 & MILLWORK SHOP DRAWINGS. PROVIDE BASE [B-1] @ ALL CASEWORK ITEMS (V.I.F.).
- ③ SECURE BASE TILE @ WALK-IN W/ EPOXY ADHESIVE.
- ④ REFER TO DETAIL 3/A1.1 FOR TYPICAL BASE IN KITCHEN AREA & AREAS TO RECEIVE QUARRY TILE BASE. [B-2]
- ⑤ REFER TO DETAIL 2/A1.1 FOR TYP. BASE IN RESTROOM RECEIVING. [B-3]
- ⑥ REFER TO DETAIL 2/A1.1 FOR TYP. BASE IN RESTROOM RECEIVING. [B-1]
- ⑦ ALIGN FLOOR FINISH TRANSITION W/ FINISHED FACED OF ANGLED WALL.
- ⑧ REFER ALSO TO FLOOR PLAN, SHEET A2.0 FOR MATCHING RADIOUS POINT AND RELATED DIMENSIONS.

SYMBOL KEYS:

- ☐ FLOOR DRAIN
- ☑ FINNER FLOOR DRAIN
- ☐ FLOOR SINK

GENERAL FLOOR FINISH NOTES:

1. PREFER TO PLUMBING PLANS FOR FLOOR DRAIN, FLOOR SINK, HUB DRAIN & CLEANOUT INSTALLATION. VERIFY ALL FINISHES ARE TO BE INSTALLED AROUND THESE ITEMS AND W/ PLUMBING CONTRACTOR TO ACHIEVE A CLEAN, FLUSH INSTALLATION.
2. BASE NOT REQUIRED @ STOREFRONTS EXTENDING TO FLOOR.
3. REFER ALSO TO INTERIOR ELEVATIONS ON SHEETS A3.0 & A3.1 FOR EXTEND OF BASE @ WALL FINISHES.

GENERAL DOOR NOTES:

1. ALL HARDWARE SHALL BE FURNISHED AND INSTALLED BY THE GENERAL CONTRACTOR UNLESS NOTED OTHERWISE.
2. SEE HARDWARE SETS FOR REQ'D. FINISHES.
3. ALL DOORS TO BE KEVED ALIKE TO MASTER BLDG. SYSTEM AS APPLICABLE.
4. HOLLOW METAL FRAMES SHALL BE 16 GA. STEEL.
5. ALL DOORS SHALL HAVE ADA APPROVED TYPE HARDWARE (VERIFY IN FIELD).
6. EXISTING EXIT HARDWARE SHALL COMPLY WITH ALL APPLICABLE CODES. (V.I.F.).
7. THE MAXIMUM DIMENSION FROM THE TOP OF THE THRESHOLD TO THE EXTERIOR LANDING @ EXISTING DOORS SHALL NOT EXCEED 1/2". (VERIFY IN FIELD).
8. ALL GLAZING IN DOORS AND WITHIN A 24" ARC OF THE SIDES OF EGRESS DOORS SHALL BE OF AN APPROVED SAFETY TYPE. (VERIFY IN FIELD).
9. PAINT HOLLOW METAL FRAMES & DOORS PER THE SCHEDULE FOR FINISHES. SEE HIGH GLOSS ACRYLIC ENAMEL FOR ELEVATIONS & FINISH SCHEDULE.
10. PROVIDE SIGNS @ EXISTING DINING ROOM DOORS TO READ THIS EXIT MUST BE KEPT CLEAR. SIGNS SHALL BE 1" TALL & MOUNTED ON A CONTRASTING BACKGROUND.
11. ADJUST CLOSERS @ EXISTING DINING ROOM DOORS SUCH THAT SWEEP PERIOD FROM AN OPEN POSITION OF 70 DEGREES, THE DOORS SHALL TAKE AT LEAST 3 SECONDS TO MOVE TO A POINT FROM THE LATCH, MEASURED TO THE OPENING FORCE OF DOORS SHALL BE 5 LBF.
12. DOOR SETS DO NOT REPORT ALL INTERIOR FINISHES REFER TO INTERIOR ELEVATIONS & FINISH MATERIAL SCHEDULE FOR REQ'D FINISHES.

ROOM NAME

NO.	ROOM NAME
1	DINING AREA
2	WALK-IN COOLER/ FREEZER AREA
3	STORAGE AREA
4	BAKING AREA
5	PREPARATION AREA
6	FOOD PRODUCTION AREA
7	DRIVE-THRU AREA
8	WOMEN'S REST ROOM
9	VESTIBULE
10	OFFICE ROOM

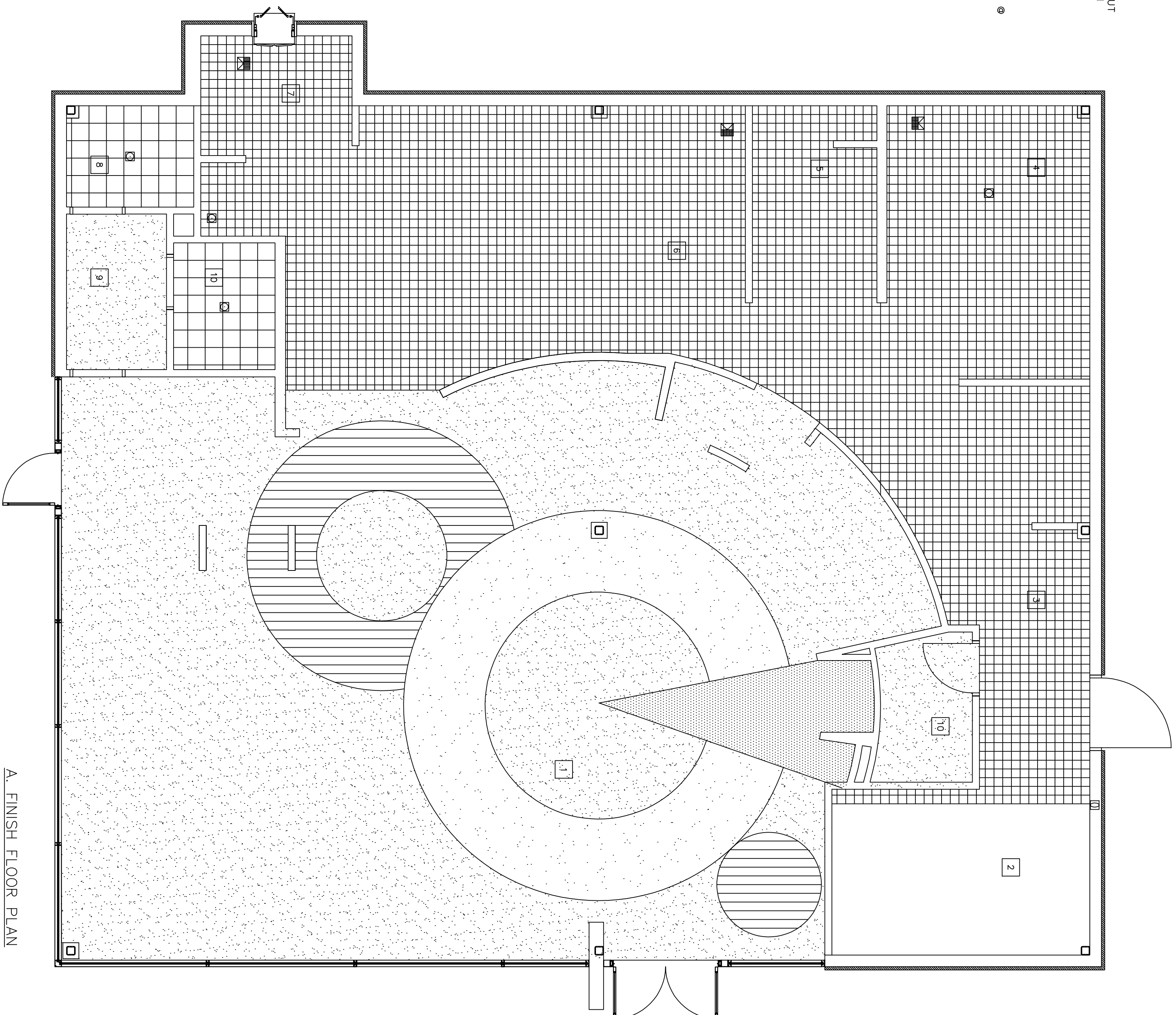

A. FINISH FLOOR PLAN
SCALE: 1/4" = 1'-0"
AREA: 3100 SQ.FT.

DOOR SCHEDULE

NO.	DIMENSION	DOOR MATERIAL	FRAME MATERIAL	FRAMER TYPE	FINISHES	HDWR	REMARKS
①	3'-0"x7'-0"x1 3/4"	INSUL.	HOLLOW MTL.	1 2 3	N/A N/A N/A	-	REFER TO GENERAL DOOR NOTES
②	3'-0"x6'-10"x2"	S.C. WOOD	HOLLOW MTL.	1 2 3	N/A N/A N/A	-	REFER TO GENERAL DOOR NOTES
③	3'-0"x6'-8"x1 3/4"	S.C. WOOD	HOLLOW MTL.	1 2 3	N/A N/A N/A	-	REFER TO GENERAL DOOR NOTES
④	4'-0"x6'-8"x1 3/4"	S.C. WOOD	HOLLOW MTL.	1 2 3	N/A N/A N/A	-	REFER TO GENERAL DOOR NOTES
⑤	3'-0"x6'-8"x1 3/4"	S.C. WOOD	HOLLOW MTL.	1 2 3	N/A N/A N/A	-	REFER TO GENERAL DOOR NOTES
⑥	3'-0"x6'-8"x1 3/4"	S.C. WOOD	HOLLOW MTL.	1 2 3	N/A N/A N/A	-	REFER TO GENERAL DOOR NOTES
⑦	3'-0"x6'-8"x1 3/4"	S.C. WOOD	HOLLOW MTL.	1 2 3	N/A N/A N/A	-	REFER TO GENERAL DOOR NOTES

HARDWARE SCHEDULE

SET A	SET B		
3 HINGES	HAGER BB1279 4.5X4.5X652XMS 3	HINGES	BB1279 4.5X4.5X652XMS
1 PULL	TRIMCO 1013-3X613	LOOKSET	FALCON T521XDANEK626
1 PUSH PLATE	TRIMCO 1013-3X613	CLOSER	LN
1 CLOSER	LN P4041YALXSNB	KICKPLATE	TRIMCO 8"X34"X626X3MS
2 KICKPLATE	TRIMCO 8"X34"X613XMS	FLOOR STOP	TRIMCO 1211X626
1 FLOOR STOP	TRIMCO 1211X613		
1 THRESHOLD	N.G.P. 424 DKB 36"		

FLOOR FINISH FF-#

CODE	MATERIAL	MANUFACTURER	SERIES	COLOR	LOCATION	DIMENSIONS	ADDITIONAL INFORMATION
FF-1	VINYL PLANKS	ARMSTRONG	NATURAL ORATIONS MYSIX	PLANK BAMBOO NIGHT BLOSSOM	DINING	4"X36"	
FF-2	VINYL TILE	ARMSTRONG	NATURAL ORATIONS MYSIX	STRAND OAK CHAMPAGNE	DINING	18"X18"	
FF-3	QUARRY TILE	METROQUATTAN	QUARRY BASICS	105 BUCKSKIN	KITCHEN	6"X6"	GROUP:G-1-1/8" JOINT
FF-4	PORCELAIN TILE	INTERGRAMICS	SLATE	IMPERIAL BLACK	RESTROOMS	12"X12"	GROUP:G-1-1/8" JOINT
FF-5	VINYL FLOORING	ARMSTRONG	NATURAL ORATIONS MYSIX	PLANK BAMBOO OTRON	DINING	4"X36"	

BASE B-#

B-1	RUBBER BASE/COKE	ROPPE	700 SERIES TPR	PR100 BLACK	6"X120" ROLL	DINING	SEE DTL. 1/A1.1 PROVIDE PERFORMED INSIDE/OUTSIDE CORNERS
B-2	QUARRY TILE	METROQUATTAN	QUARRY TEXTURES	105 BUCKSKIN	5"X6"	WALL BASE KITCHEN	SEE DTL. 3/A1.1; GROUP:G-1-3/8" JOINT
B-3	GLAZED TILE	AMERICAN OLEAN	AS601	BLACK GLOSS 0049	6"X6"	RESTROOMS	SEE DTL. 2/A1.1; GROUP:G-2-1/16" JOINT

GROUT G-#

G-1	GROUT (EPOXY)	LATICRETE	SPECTRALOCK PRO	22 MIDNIGHT BLACK	FLOORS
FF-2	GROUT (UNMODIFIED)	LATICRETE	LATICRETE 1600	22 MIDNIGHT BLACK	WALLS

PAINT P-#

P-1	PAINT	SHERWIN WILLIAMS	PROCLASSIC & DURATION	WHITE TO MATCH WC-2	DOORS/FRAMES/CEILING @ KITCHEN
P-2	PAINT	SHERWIN WILLIAMS	DURATION	SW6109 HOPSACK	WALLS
P-3	PAINT	SHERWIN WILLIAMS	DURATION	SW6321 RED BAY	WALL & CEILING ACCENTS
P-4	PAINT	SHERWIN WILLIAMS	DURATION	SW6918 HUMOROUS GREEN	CEILING ACCENTS
P-5	PAINT	SHERWIN WILLIAMS	DURATION	SW6909 LOBELIA	WALL & CEILING ACCENTS
P-6	PAINT	SHERWIN WILLIAMS	DURATION	SW6808 CECESTIAL	WALLS & CEILING
P-7	PAINT	SHERWIN WILLIAMS	DURATION	BLACK TO MATCH STOREFRONT	EXPOSED COL. @ STOREFRONT/MISC.

STAIN S-#

S-1	WOOD STAIN	CUSTOM	T.B.D.	MATCH PL-1	CHAIR RAIL & MISC. TRIM
-----	------------	--------	--------	------------	-------------------------

WALL COVERING WC-#

WC-1	WALL PAPER	WDC WALLCOVERINGS	ANGELA ADAMS	AA44603/1120, LULU HONEY	DINING ROOM WAINSCOT	54" WDC	FURNISHED BY OWNER'S VENDOR, INSTALLED BY G.C.
WC-2	MANUFACTURED VANILITE	MANULITE	P100-FR	WHITE	KITCHEN/UTILITY ROOM	-	PERMILE
WC-3	GLAZED CERAMIC TILE	AMERICAN OLEAN	AS601	BLACK GLOSS 0049SB00	RESTROOM WALL	3"X6"	PROVIDE SPECIAL CORNER UNITS.
WC-4	GLAZED CERAMIC TILE	AMERICAN OLEAN	AS601	BLACK GLOSS 0049SB00	RESTROOM WALL	3"X6"	GROUP:G-2-1/16" JOINT

Rev.	By	Date

SCHLOTZSKY'S
@ VICTORY LAKETOWN CENTER
TRACT 7A NEC INTERSTATE HWY 45 & F.M.646
LEAGUE CITY, TEXAS 77573

ARCH
Woo Associates, LLC.

ARCHITECTS - PLANNERS
13734 Branford Green Dr.
Houston, TX 77083
(281) 530-3192

Date	05-26-2010
Scale	AS SHOWN
Drawn by	KW
Job#:	VICTORY LAKE

A2.1