

**01 LUCA & LEONARDO - LEVEL 2**  
SCALE = 3/16" = 1'-0"

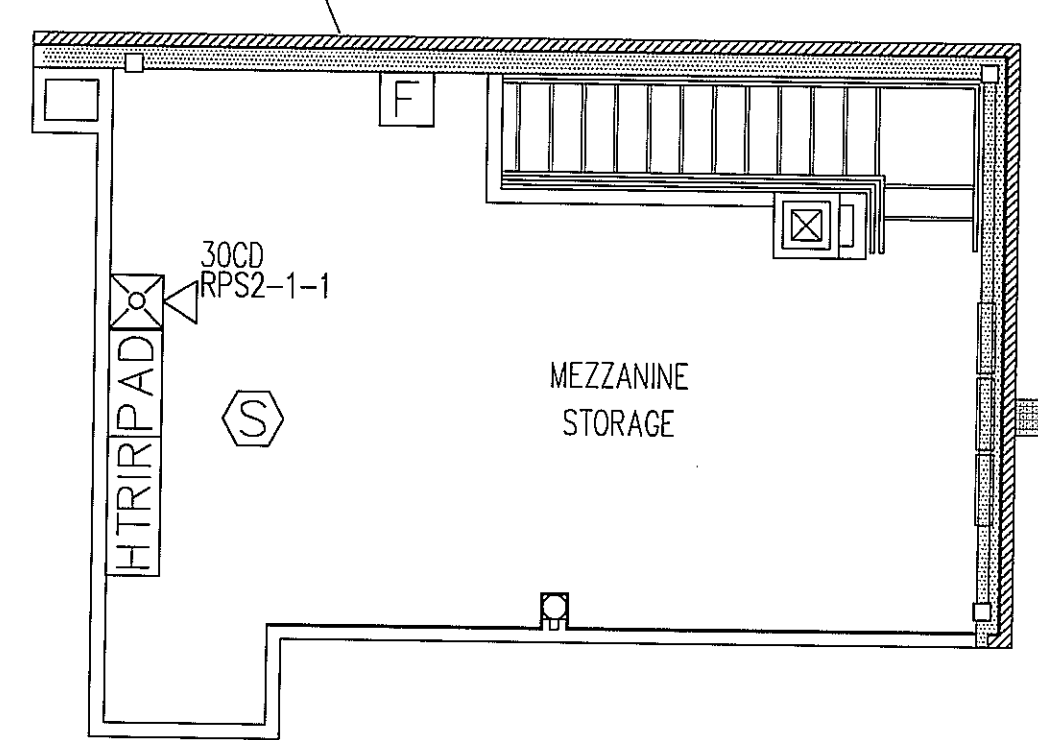

**02 MEZZANINE STORAGE - LEVEL 2**  
SCALE = 3/16" = 1'-0"

**KEYED FIRE ALARM INSTALLATION NOTES:**

- REMOTE POWER SUPPLY:**  
ELECTRICAL CONTRACTOR TO MOUNT THE NEW REMOTE POWER SUPPLY IN THE MEZZANINE STORAGE ROOM ABOVE THE KITCHEN. PROVIDE DEDICATED 120VAC INTO THE TOP LEFT HAND KNOCKOUT. ALSO PROVIDE A 1" CONDUIT STUB WITH INSULATED THROAT CONNECTOR INTO ACCESSIBLE CEILING SPACE FROM THE TOP RIGHT HAND KNOCKOUT. ELEC CONTRACTOR TO PROVIDE A 4" SQ 2-1/8" DEEP BOX NEXT TO THE REMOTE POWER SUPPLY. INSTALL A 3/4" OFFSET NIPPLE FROM THE 4" SQ 2-1/8" DEEP BOX INTO THE REMOTE POWER SUPPLY. FSPS CONTRACTOR TO INSTALL A HTRI-R MODULE TO ACTIVATE AND SUPERVISE THE REMOTE POWER SUPPLY.
- KITCHEN HOOD:**  
ELECTRICAL CONTRACTOR TO PROVIDE A 4" SQ 2-1/8" DEEP BOX AND 3/4" CONDUIT STUB WITH INSULATED THROAT CONNECTOR INTO ACCESSIBLE CEILING SPACE. FSPS CONTRACTOR TO INSTALL A HTRI-D MODULE TO MONITOR BOTH KITCHEN HOOD SYSTEMS. ALL SLC WIRING SHALL BE 18/2 AWG RED WITH THE YELLOW STRIPE.
- NOTIFICATION APPLIANCES:**  
ELECTRICAL CONTRACTOR TO PROVIDE A 4" SQ 2-1/8" DEEP BOX AT 80" AFF TO THE BOTTOM OF THE BOX. ALSO PROVIDE A 3/4" CONDUIT STUB WITH INSULATED THROAT CONNECTOR INTO ACCESSIBLE CEILING SPACE. ALL STROBES TO BE 15cd UNLESS OTHERWISE NOTED. ALL NOTIFICATION WIRING SHALL BE 18/2 AWG FPLP SOLID RED.
- HEAT/SMOKE DETECTION:**  
ELECTRICAL CONTRACTOR TO PROVIDE A 4" OCTAGON BOX AND CADDY BAR SUPPORT. DETECTORS SHALL NOT BE INSTALLED WITHIN 3' OF A RETURN OR SUPPLY AIR DIFFUSER. TIE ALL NEW SLC DEVICES INTO THE NEAREST EXISTING SLC DEVICE. ALL SLC WIRING SHALL BE 18/2 AWG FPLP RED WITH THE YELLOW STRIPE.  
  
THE ELECTRICAL CONTRACTOR SHALL PROVIDE A CONDUIT RACEWAY IN EACH MECHANICAL, ELECTRICAL, TELEPHONE, ELEVATOR MACHINE, PARKING GARAGE AND FIRE PUMP ROOM AND ANY OTHER AREA WHERE THE FIRE ALARM WIRING MIGHT BE SUBJECT TO DAMAGE.  
  
ELECTRICAL CONTRACTOR TO PROVIDE GROMMETS IN ALL BACKBOXES.  
  
ELECTRICAL CONTRACTOR SHALL BE RESPONSIBLE FOR PROVIDING AND INSTALLING: ALL CONDUIT, FITTINGS, ALL STANDARD ELECTRICAL BOXES, PENETRATIONS, FIREPROOFING; MOUNTING OF BACK BOXES, AND CONDUIT FOR FIRE ALARM POWER SUPPLIES, AND CONNECTION TO ALL NON-LOW VOLTAGE DEVICES.  
  
\*\*ALL DEVICE ADDRESSING SHALL BE COORDINATED WITH THE FSPS PROGRAMMER.\*\*  
**\*\*\*DETECTORS SHALL NOT BE INSTALLED UNTIL AFTER THE CONSTRUCTION CLEANUP OF ALL TRADES IS COMPLETE AND FINAL. PER NFPA 2002 EDITION 5.7.1.11\*\*\***

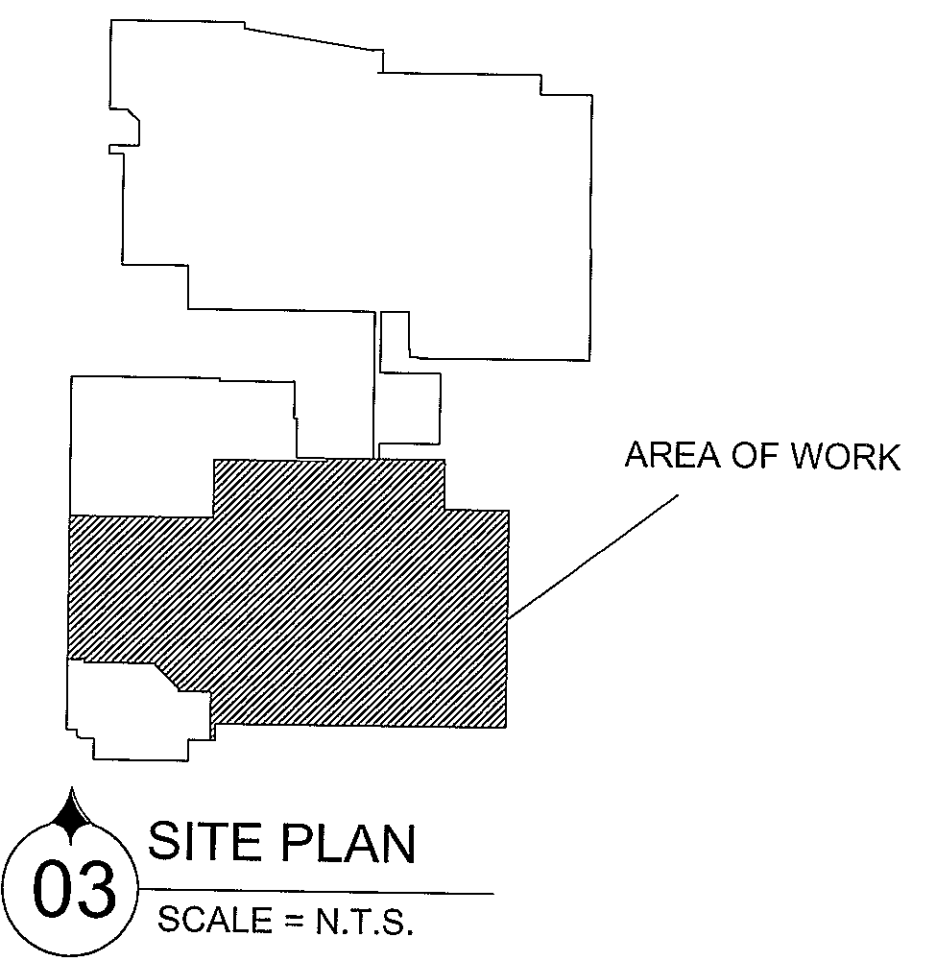

NOT IN CONTRACT / NO WORK IN THIS AREA	
FIRE ALARM SYMBOL LEGEND	
<b>PAD</b>	REMOTE POWER SUPPLY: ELECTRICIAN TO PROVIDE DEDICATED 120VAC INTO THE TOP LEFT KNOCKOUT. ALSO PROVIDE A 1" CONDUIT STUB WITH INSULATED THROAT CONNECTOR INTO ACCESSIBLE CEILING SPACE. POWER SUPPLY DIMENSIONS = 12"W x 16"H x 3"D.
<b>HTRI-R</b>	INTELLIGENT INTERFACE MODULE W/SINGLE INPUT AND RELAY. REQUIRES A 4" SQ 2-1/8" DEEP BOX AND 3/4" CONDUIT STUB WITH INSULATED THROAT CONNECTOR INTO ACCESSIBLE CEILING SPACE.
<b>F</b>	MANUAL PULL STATION AT 42" AFF. TO THE BOTTOM OF THE DEVICE. REQUIRES A SINGLE-GANG 2-1/2" BOX AND 3/4" CONDUIT STUB WITH INSULATED THROAT CONNECTOR. MANUAL PULL STATION MUST BE LOCATED WITHIN 5' OF EGRESS DOOR.
<b>HTRI-D</b>	INTELLIGENT DUAL INPUT MODULE. REQUIRES A 4" SQ 2-1/8" DEEP BOX AND A 3/4" CONDUIT STUB WITH INSULATED THROAT CONNECTOR INTO ACCESSIBLE CEILING SPACE.
<b>H</b>	CEILING HEAT DETECTOR. REQUIRES A 4" OCTAGON BOX WITH CADDY-BAR SUPPORT WHEN INSTALLED IN LAY-IN CEILING TILE.
<b>S</b>	CEILING SMOKE DETECTOR. REQUIRES A 4" OCTAGON BOX WITH CADDY-BAR SUPPORT WHEN INSTALLED IN LAY-IN CEILING TILE. "X" - DENOTES RELAY BASE.
<b>X</b>	WALL MOUNTED STROBE. ELEC CONTRACTOR TO PROVIDE A 4" SQ 2-1/8" DEEP BOX AT 80" AFF TO THE BOTTOM OF THE BOX WITH A 3/4" CONDUIT STUB WITH INSULATED THROAT CONNECTOR INTO ACCESSIBLE CEILING SPACE. ALL STROBES TO BE 15cd UNLESS OTHERWISE NOTED. INSTALLING CONTRACTOR TO ENSURE ALL VISUAL DEVICES LOCATED ON PLANS MEET THE PROPER SPACING AND ADA REQUIRED CANDELA SETTINGS PER NFPA72.
<b>X</b>	WALL MOUNTED HORN/STROBE. ELEC CONTRACTOR TO PROVIDE A 4" SQ 2-1/8" DEEP BOX AT 80" AFF TO THE BOTTOM OF THE BOX WITH A 3/4" CONDUIT STUB WITH INSULATED THROAT CONNECTOR INTO ACCESSIBLE CEILING SPACE. ALL STROBES TO BE 15cd UNLESS OTHERWISE NOTED. INSTALLING CONTRACTOR TO ENSURE ALL VISUAL DEVICES LOCATED ON PLANS MEET THE PROPER SPACING AND ADA REQUIRED CANDELA SETTINGS PER NFPA72.
E = DENOTES EXISTING DEVICE TO REMAIN E/R = DENOTES EXISTING DEVICE THAT IS RELOCATED	
FIRE ALARM POINT DESCRIPTIONS	
	INDICATES RPS NO. (TYP.)
	INDICATES RPS CIRCUIT NO. (TYP.)
	INDICATES DEVICE WIRING SEQUENCE (TYP.)
	INDICATES ADDRESSABLE LOOP (TYP.)
	INDICATES DEVICE ADDRESS (TYP.)
RPS1-1-1	1:001

**FIRE MARSHAL NOTES:**  
SCOPE OF PROJECT

THE SYSTEM ADDITIONS CONSIST OF ADDING HEAT/SMOKE DETECTION, MANUAL PULLS, KITCHEN HOOD MONITORING, AUDIBLE AND VISUAL DEVICES TO THE EXISTING FIRE ALARM CONTROL PANEL. THE FIRE ALARM CONTROL PANEL IS LOCATED IN A NORMALLY ATTENDED AREA.

**FIRE ALARM SEQUENCE OF OPERATION**

THE EXISTING BUILDING SYSTEM SEQUENCE OF OPERATION WILL NOT BE AFFECTED.

ALL AUTOMATIC EVENTS PROGRAMMED TO THE ALARM POINT SHALL BE EXECUTED AND THE ASSOCIATED INDICATING DEVICES AND/OR OUTPUTS ACTIVATED.

THE FIRE ALARM SYSTEM DESIGN MEETS THE REQUIREMENTS OF THE 2006 IBC AND IFC AND THE 2002 EDITION OF NFPA 72

THIS FACILITY IS 100% SPRINKLED.

<input checked="" type="checkbox"/>	FOR SUBMITTAL	<input type="checkbox"/>	RECORD DRAWINGS
I have reviewed these plans and certify that they comply with the applicable codes and standards; or			
I certify they were copied from sealed engineering plans and any violations of the applicable codes or standards are specifically noted on these plans.			
Fire Safe Protection Services, LP 1815 Sherwood Forest Houston, Texas 77043 713-722-7800 ACR-83231-581			
APS Licensee Signature - License #		APS-0982	
Jonathan M. Hermis		Date	
09/14/2010			

PROJECT: 20 WATERWAY LUCA & LEONARDO 20 WATERWAY AVENUE THE WOODLANDS, TEXAS 77380  
 FSPS PROJECT NO. 10-0331  
 FSPS DRAWING NO. FA-2  
 FIRE ALARM SYSTEM GENERAL LAYOUT  
 FIRE SAFE PROTECTION SERVICES, LP  
 1815 SHERWOOD FOREST HOUSTON, TEXAS 77043  
 TEL: (713) 722-7800 FAX: (713) 722-7800  
 http://www.fire-safe.net  
 ACP# 83231-581