



ISSUE
 09-10-10 ISSUED FOR PERMIT
 10-08-10 DBR REVIEW COMMENTS
 11-02-10 ISSUED FOR CONSTRUCTION

ELECTRICAL GENERAL NOTES:
 (FOR SHEET E2.00)

- REFER TO ARCHITECTURAL DRAWINGS FOR EXACT LOCATION AND MOUNTING HEIGHTS OF ALL ELECTRICAL OUTLETS.
- EACH CONDUIT SHALL BE LIMITED TO (3) CIRCUITS MAXIMUM.
- NO MORE THAN THREE SINGLE PHASE CIRCUITS AND NO MORE THAN SIX CURRENT CARRYING CONDUCTORS SHALL BE INSTALLED IN A SINGLE RACEWAY. WHEN FOUR, FIVE, OR SIX CURRENT CARRYING CONDUCTORS ARE INSTALLED IN A SINGLE RACEWAY, THEIR CURRENT CARRYING CAPACITIES SHALL BE DERATED AS REQUIRED BY THE NEC FOR NON-DIVERSIFIED LOADS. THE INSTALLED WIRE SIZE SHALL HAVE A NOMINAL AMPACITY RATING OF 125% OF THAT REQUIRED OR SPECIFIED WHEN FOUR OR MORE CURRENT CARRYING CONDUCTORS ARE INSTALLED IN A SINGLE RACEWAY. NEUTRAL CONDUCTORS SHALL BE CONSIDERED A CURRENT CARRYING CONDUCTOR IN ALL NON-LINEAR LOADED CIRCUITS AS REQUIRED BY THE NEC.
- VERIFY MOUNTING HEIGHTS OF RECEPTACLES WITH CASEWORK ELEVATIONS PRIOR TO ROUGH-IN. REFER TO ARCHITECTURAL DRAWINGS FOR ROOM ELEVATIONS FOR LOCATION AND COORDINATION OF ELECTRICAL OUTLETS. AT KNEESPACE LOCATIONS, LOCATE ELECTRICAL OUTLETS WITHIN KNEESPACE, UNLESS NOTED OTHERWISE. AT COUNTERTOPS WITH OUT KNEESPACE, LOCATE OUTLETS HORIZONTALLY 6" ABOVE BACK SPLASH, UNLESS NOTED OTHERWISE.
- ALL RECEPTACLE, AND EQUIPMENT BRANCH CIRCUIT CONDUITS SHALL CONTAIN A GROUND WIRE, USING THE CONDUIT SYSTEM AS THE ONLY GROUND PATH IS NOT ACCEPTABLE.
- ELECTRICIAN OF RECORD, & BONDED PER DIVISION 0-"CONTRACT" SPECIFICATIONS, AND BE FAMILIAR & EXPERIENCED WITH SUCH WORK INDICATED HEREIN, & QUALIFIED BY MOST RECENT OSHA CERTIFICATION TO WORK ON ENERGIZED EQUIPMENT. REFER TO & COMPLY WITH OSHA 29CFR.1910 & 1926 ELECTRICAL SAFETY PORTIONS. CONSTRUCTION METHOD AND MEANS AND THEIR REQUIREMENTS. CONTRACTOR SHALL PROVIDE WORK WITHIN STANDARD OF CARE FOR PROFESSION.
- MOUNT ALL RECEPTACLES AT +18" A.F.F. UNLESS OTHERWISE NOTED.
- REFER TO SHEET E6.00 FOR SYMBOL LEGEND.
- ALL ELECTRICAL WORK INCLUDED IN THIS PROJECT SHALL MEET THE REQUIREMENTS OF THE 2008 NATIONAL ELECTRICAL CODE (N.E.C.).
- TEMPORARY POWER & HEAT ARE PROVIDED BY OTHERS.
- REFER TO SHEET E2.01 FOR KITCHEN EQUIPMENT SCHEDULE.
- COORDINATE ALL FINAL ROUGH-IN LOCATIONS OF TELEVISIONS WITH OWNER. PROVIDE CATV CABLING AND POWER AS REQUIRED.
- REFER TO SHEET E2.02 FOR HVAC & ELECTRICAL EQUIPMENT LOCATED IN MEZZANINE ABOVE.
- REFER TO SHEET E2.03 FOR HVAC & ELECTRICAL EQUIPMENT LOCATED IN MEZZANINE ABOVE.

ELECTRICAL KEYED NOTES:
 (FOR SHEET E2.00)

- FIELD VERIFY EXACT LOCATION AND ACCESS FOR TENANT SIGNAGE. PROVIDE TIMECLOCK FOR ON/OFF CONTROL OF SIGN.
- REFER TO DETAIL #1 ON SHEET E2.01 FOR PLAN OF THIS AREA.
- REFER TO DETAIL #2 ON SHEET E2.01 FOR PLAN OF THIS AREA.
- FURNISH AND INSTALL PEDESTAL MOUNTED WEATHERPROOF WHILE IN USE GFCI RECEPTACLE REFER TO DETAIL #7 ON SHEET E5.00.

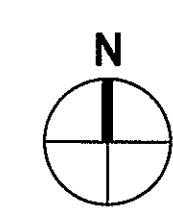
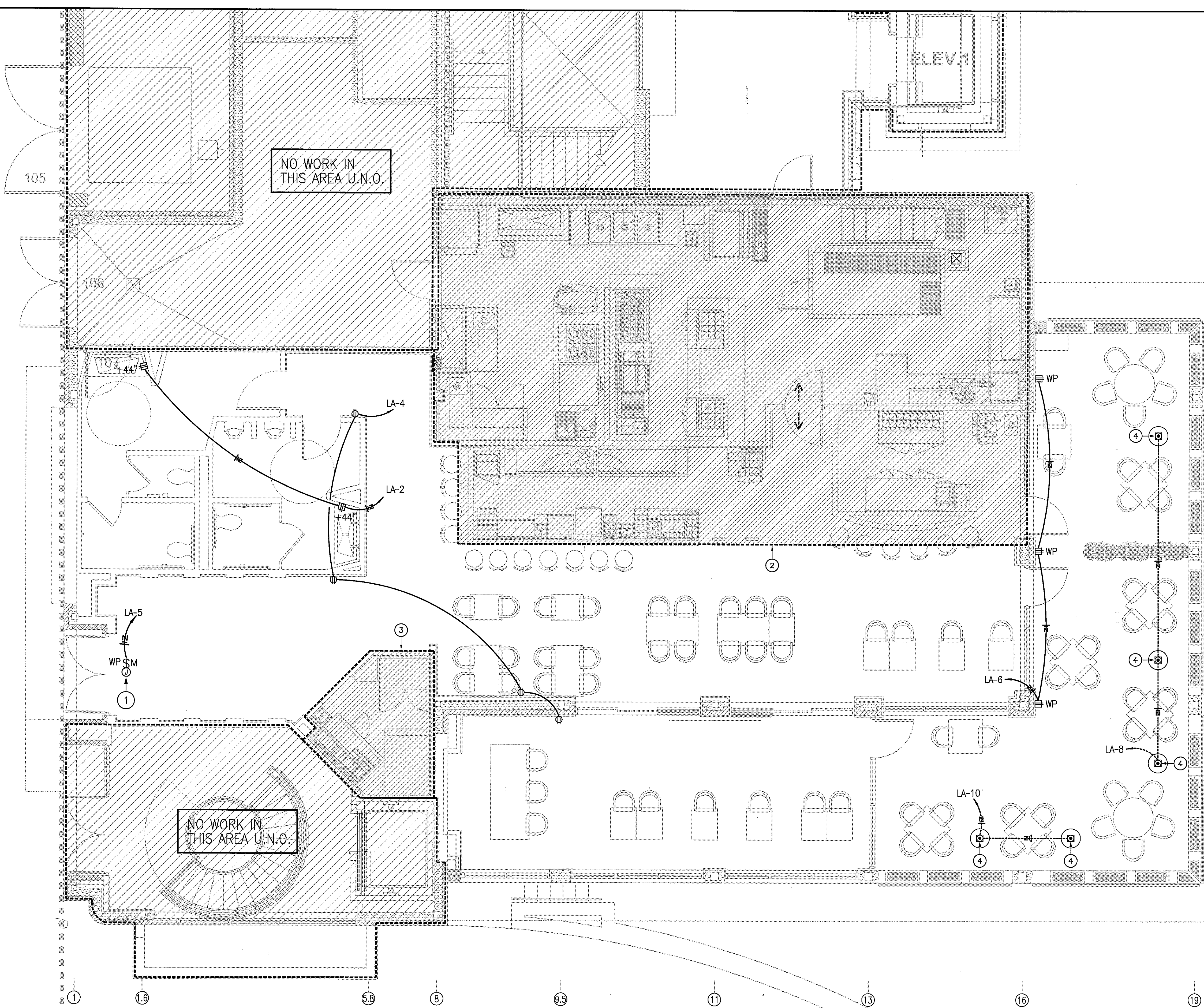

1 ELECTRICAL POWER PLAN - 1st FLOOR
 SCALE: 1/4" = 1'-0"

HARRELL
 ARCHITECTS, L.P.

9575 Katy Fwy., #200
 Houston, Texas 77024
 tel: 713.722.7071
 fax: 713.722.7072

CONSULTANTS
HOLSTE & ASSOCIATES
 MEP Engineers

Holste & Associates, Inc.
 Consulting Engineers - Texas Reg. E-5443
 6671 Southwest Fwy., Suite 850
 Houston, Texas 77074 (713) 956-1251
 www.holstemep.com

PROJECT NAME
LUCA & LEONARDO
 RESTAURANT
LUCA & LEONARDO
 RESTAURANTE

PROJECT ADDRESS
 20 WATERWAY
 THE WOODLANDS, TEXAS

PROJECT NUMBER
 10018
 SHEET NAME
ELECTRICAL POWER PLAN
 SHEET NUMBER

E2.00