

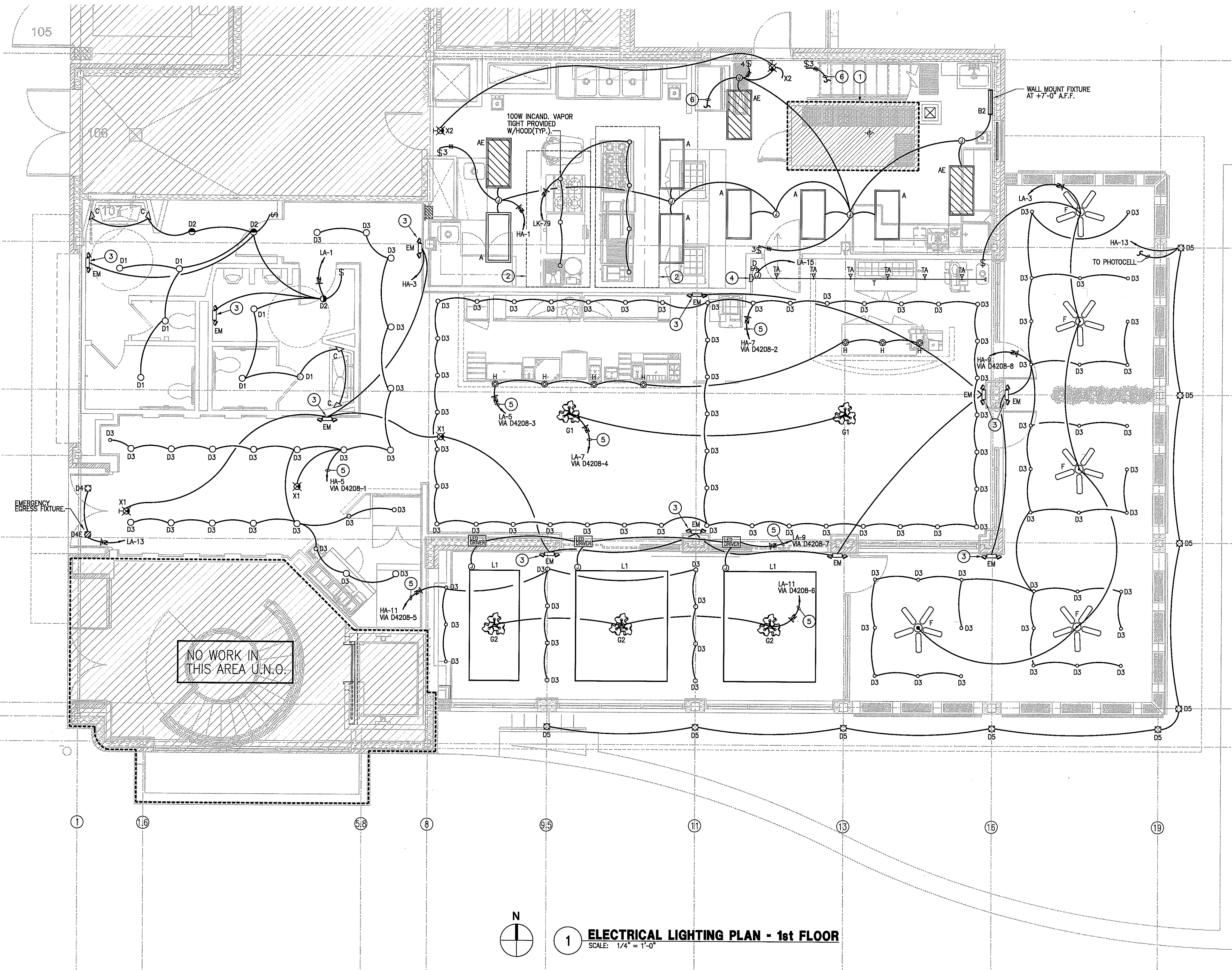

ISSUE
 09-10-10 ISSUED FOR PERMIT
 10-08-10 DBR REVIEW COMMENTS
 11-02-10 ISSUED FOR CONSTRUCTION



- ELECTRICAL KEYED NOTES:**
 (FOR SHEET E1.00)
- 1 REFER TO SHEET E2.01 FOR COOLER LIGHTING REQUIRED
 - 2 HOOD LIGHT SWITCH PROVIDED BY HOOD MANUFACTURER.
 - 3 MOUNT EMERGENCY LIGHTING UNIT AT 6" BELOW FINISHED CEILING.
 - 4 PROVIDE LEVITON #D4208 ARCHITECTURAL LIGHTING CONTROL SYSTEM FOR DIMMING AND SCENE CONTROL OF MAIN DINING, BAR, AND LOBBY LIGHTING CIRCUITS. INTEGRATED ASTRONOMICAL TIME CLOCK FOR AUTO SHUT-OFF. OWNER TO COORDINATE PROGRAMMING OF SCENES W/ CONTRACTOR. AUTOMATIC FADE IN/OUT FROM ONE SCENE TO NEXT IS POSSIBLE. REFER TO DETAIL #2 ON SHEET E3.2 FOR MORE INFORMATION.
 - 5 TO DIMMING CONTROL SYSTEM. REFER TO DETAIL #2 ON SHEET E3.2 FOR MORE INFORMATION.
 - 6 UP TO LIGHTS IN MEZZANINE ABOVE. REFER TO SHEET E1.01 FOR CONTINUATION.

PER N.E.C. 220.43(B) TRACK LIGHTING: DO NOT EXCEED 150 WATTS PER TWO FEET OF LINEAR TRACK OR 75 WATTS PER LINEAR FOOT. WHEN MULTI-CIRCUIT TRACK IS INSTALLED, THE LOAD SHALL BE DIVIDED EQUALLY BETWEEN THE TRACK CIRCUITS.

1 ELECTRICAL LIGHTING PLAN - 1st FLOOR
 SCALE: 1/4" = 1'-0"

HARRELL
 ARCHITECTS, LP

9575 Katy Frwy., #200
 Houston, Texas 77024
 tel: 713.722.7071
 fax: 713.722.7072

CONSULTANTS
HOLSTE & ASSOCIATES
 MEP Engineers

Holste & Associates, Inc.
 Consulting Engineers - Texas Reg. F-5448
 6675 Southwest Frwy., Suite 300
 Houston, Texas 77074 (713) 995-1351
 www.holstemep.com

PROJECT NAME

LUCA & LEONARDO RESTAURANT

LUCA & LEONARDO
 RESTAURANTE

PROJECT ADDRESS

20 WATERWAY
 THE WOODLANDS, TEXAS

PROJECT NUMBER

10018

SHEET NAME

ELECTRICAL LIGHTING PLAN

SHEET NUMBER

E1.00