

# ELECTRICAL PLAN NOTES

E.C. TO COORDINATE WITH MECHANICAL CONTRACTOR FOR ELECTRICAL REQUIREMENTS FOR HEATING AND COOLING EQUIPMENT.

E.C. TO COORDINATE WITH PLUMBING CONTRACTOR FOR HOT WATER HEATER ELECTRICAL REQUIREMENTS.

ALL DEVICE AND COVERPLATE ASSEMBLIES SHALL BE COLOR: FILL IN DEVICES SHOWN SIDE-BY-SIDE SHALL BE MOUNTED STRAIGHT, LEVEL, AND AS CLOSE TOGETHER AS POSSIBLE ON THE HORIZONTAL PLANE.

DEVICES SHOWN "STACKED" SHALL BE MOUNTED STRAIGHT, LEVEL, AND ALIGNED VERTICALLY AT 15" A.F.F. U.N.O.

VERIFY SWITCHING WITH TENANT, U.N.O.

ALL LIGHT SWITCHES SHALL BE INSTALLED NO MORE THAN 6" FROM ROUGH OPENING OF DOOR, U.N.O.

G.C. TO COORDINATE EXACT LOCATION OF ALL ELECTRICAL DEVICES W/ FIELD DIMENSIONED CASEWORK SHOP DRAWINGS. ANY DISCREPANCIES ARE TO BE BROUGHT TO THE ATTENTION OF THE ARCHITECT PRIOR TO INSTALLATION OF ELECTRICAL DEVICES.

- ① VERIFY ELECTRICAL REQUIREMENTS FOR HVAC
- ② ELEVATOR ELECTRICAL TYPICAL:  
ONE 240 VOLT 30 AMP DEDICATED SERVICE 10-3 WIRE WITH GROUND IN 4X4 ELECTRICAL BOX AND ONE 120 VOLT, 20 AMP SERVICE IN 4X4 ELECTRICAL BOX, TELEPHONE LINE, GFI RECEPTACLE, LIGHT FIXTURE WITH BULB GUARD AND SWITCH, SHALL ALL BE LOCATED IN ELEVATOR HOISTWAY OVERHEAD OR IN ATTIC DEPENDING ON LOCATION OF ACCESS DOOR.

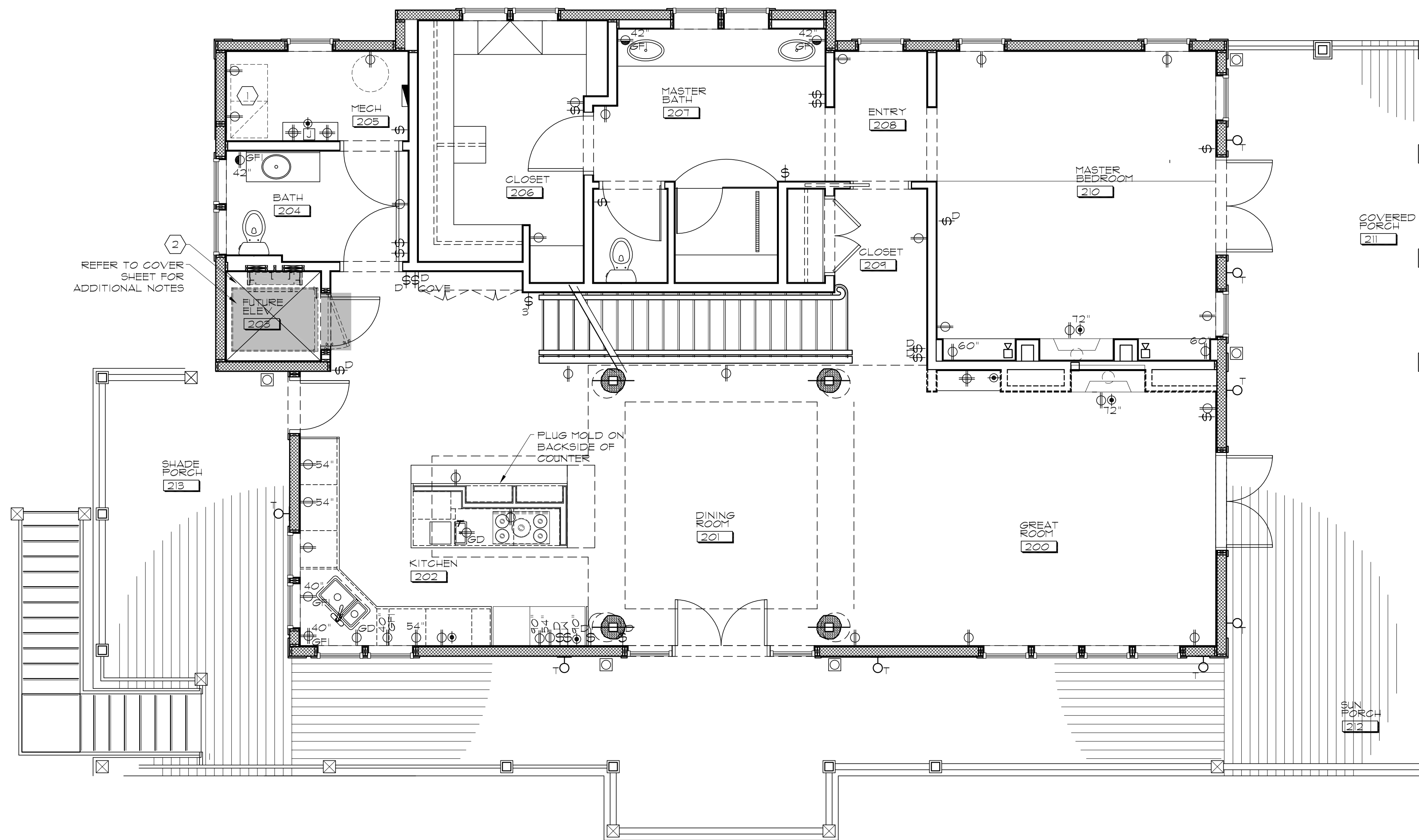

# ELECTRICAL LEGEND

- |           |  |
|-----------|--|
| ROOM NAME | ROOM NAME & NUMBER   |
| ②         | REFER TO COVER SHEET FOR ADDITIONAL NOTES  |
| ⑥         | PLAN NOTE  |
| ⊕         | SINGLE ELECTRICAL OUTLET, 220/230 VOLTS.   |
| ⊕         | DUPLEX ELECTRICAL OUTLET, 110/120 VOLTS.   |
| ⊕         | DUPLEX ELECTRICAL OUTLET, GFI  |
| ⊕         | DUPLEX ELECTRICAL OUTLET, DEDICATED CIRCUIT.                                     |
| ⊕         | DUPLEX ELECTRICAL OUTLET, ISOLATED GROUND CIRCUIT.                               |
| ⊕         | QUAD ELECTRICAL OUTLET   |
| ⊕         | QUAD ELECTRICAL OUTLET, DEDICATED  |
| ⊕         | QUAD ELECTRICAL OUTLET ISOLATED GROUND   |
| ⊕         | QUAD ELECTRICAL OUTLET, GFI  |
| ⊕         | FLOOR MOUNTED OUTLET   |
| ⊕         | MULTIPLE OUTLET/PLUG MOLD  |
| ⊕         | GROUND FAULT INTERRUPTER   |
| ⊕         | INDICATED MOUNTING HEIGHT ABOVE FINISHED FLOOR                                   |
| ⊕         | OUTDOOR WALL MOUNTED DUPLEX ELECTRICAL OUTLET, GFI                               |
| ⊕         | ONE WAY SWITCH   |
| ⊕         | THREE WAY SWITCH   |
| ⊕         | FOUR WAY SWITCH  |
| ⊕         | INDICATES SWITCH W/ DIMMER   |
| ⊕         | FIXTURES GANGED BY AREA  |
| ⊕         | INDICATES FIXTURE TO BE SWITCHED   |
| ⊕         | CABLE OR SAT. TV   |
| ⊕         | THERMOSTAT. VERIFY EXACT LOCATION & HEIGHT WITH ARCHITECT PRIOR TO INSTALLATION. |
| ⊕         | ELECTRICAL METER   |
| ⊕         | PROVIDE JUNCTION BOX   |
| ⊕         | SURFACE MOUNTED ELECTRICAL PANEL & CABINET                                       |
| ⊕         | HOT WATER HEATER   |
| ⊕         | BELL   |
| ⊕         | BUZZER   |
| ⊕         | SPEAKER @ 1'-0" AFF.   |

# MAIN LEVEL ELECTRICAL PLAN

SCALE: 1/4"=1'-0"

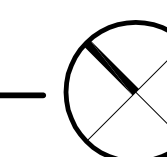

SHEET NO. E.I.2

MAIN LEVEL ELECTRICAL / DATA LOCATION PLAN

CIN3401R

1 JUN 13

THE GRUENE HOUSE  
CINNAMON SHORE  
175 SEASIDE DR.  
PORT ARANSAS, TX 78373

REGISTERED ARCHITECT  
DANIEL BRENNER  
STATE OF TEXAS  
19288

620 N. Delaware  
Indianapolis, IN 46204  
317.262.1200 tel  
317.262.1200 fax  
www.brennerdesign.com

BRENNER DESIGN  
Architecture  
Construction Management