

PR # 1

### MEZZANINE LAYOUT

3/16" = 1'-0"

### OCCUPANCY TYPE AND LOAD

CHAP. 2 (IFC 2006),  
CHAP. 3 & 10 (IBC 2006)

| OCCUPANCY CLASSIFICATION | SPECIFIC USE                     | ▲            | ②       | ③          |
|--------------------------|----------------------------------|--------------|---------|------------|
| A-2                      | DINING FIXED                     | 566          | 18"/24" | 38         |
| A-2                      | DINING NON FIXED                 | 2,759        | 15 NET  | 183        |
| A-2                      | WAITING                          | 291          | 5 NET   | 59         |
| A-2                      | KITCHEN, BAR, STORAGE AND OFFICE | 1,926        | 200     | 10         |
| A-2                      | PATIO NON FIXED                  | 860          | 20 NET  | 43         |
| <b>TOTAL</b>             |                                  | <b>6,723</b> |         | <b>333</b> |

#### REF. IBC 2006, TABLE 1004.1.1

- ▲ LIST SQUARE FOOTAGE IN EACH OCCUPANCY CLASSIFICATION.
- ② LIST FLOOR AREA IN SQUARE FOOT PER OCCUPANT FROM IBC TABLE 1004.1.1
- ③ LIST ALLOWABLE OCCUPANTS PER OCCUPANT CLASSIFICATION.

OCCUPANT LOAD SIGN SHALL BE POSTED IN ACCORDANCE WITH IFC 2006

EGRESS REQUIRED = .2 x 290 = 58 INCHES  
EGRESS PROVIDED = 180" 4 DOORS

MINIMUM CLEAR OPENINGS = 32"

MINIMUM CLEAR WIDTH OF CORRIDORS = 44"

MAXIMUM TRAVEL DISTANCE = 250' (SPRINKLED)

MAXIMUM TRAVEL DISTANCE TO EXIT PROVIDED = 81'

### PLUMBING FIXTURES REQUIRED

CHAP. 29 (IBC 2006) 2901.1

| OCCUPANCY CLASSIFICATION | SPECIFIC USE       | REQUIRED  |           | TOTAL | PROVIDED |        |
|--------------------------|--------------------|-----------|-----------|-------|----------|--------|
|                          |                    | MALE      | FEMALE    |       | MALE     | FEMALE |
| A-2                      | WATER CLOSETS      | 1 PER 75  | 1 PER 75  | 4,4   | 3        | 3      |
| A-2                      | LAVATORIES         | 1 PER 200 | 1 PER 200 | 1,6   | 2        | 2      |
| A-2                      | TUBS AND SHOWERS   | -         | -         | -     | -        | -      |
| A-2                      | DRINKING FOUNTAINS | 1 PER 500 | 1 PER 500 | -     | -        | -      |
| A-2                      | SERVICE SINK       | 1         | -         | 1     | 2        | -      |

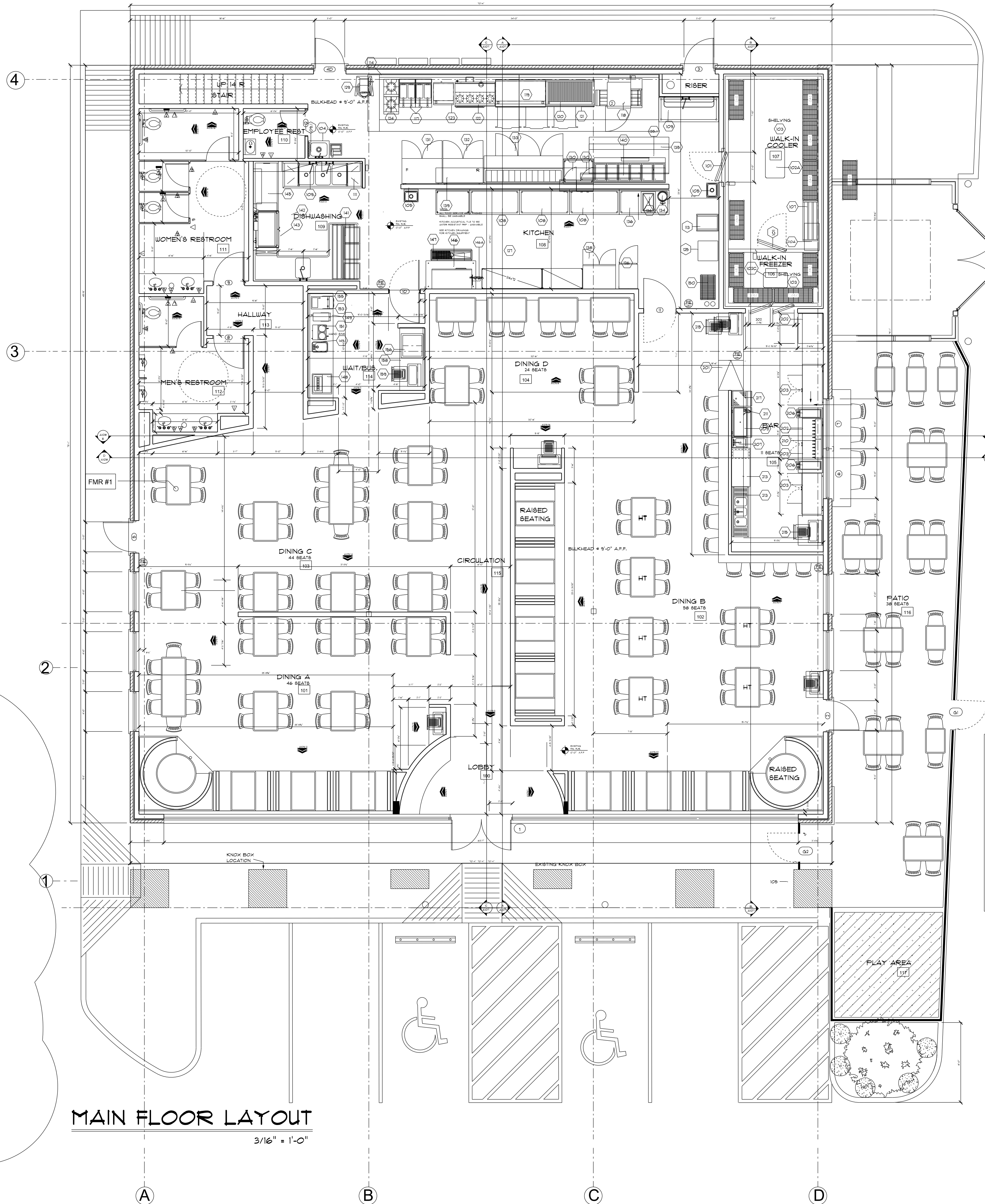

### MAIN FLOOR LAYOUT

3/16" = 1'-0"

#### TOILET ROOM ACCESSORIES

| ID | ACCESSORY                | MOUNTING HT         | REMARKS                    |
|----|--------------------------|---------------------|----------------------------|
| 1  | PAPER TOWEL              | PER MFG             | SURFACE MOUNTED SEE NOTE 2 |
| 2  | TOILET PAPER HOLDER      | PER MFG             | SURFACE MOUNTED SEE NOTE 2 |
| 3  | SANITARY NAPKIN DISPOSAL | PER MFG             | SURFACE MOUNTED SEE NOTE 2 |
| 4  | SOAP DISPENSER           | BOTT. # 3"4" A.F.F. | SEE NOTE 2                 |
| 5  | MIRROR                   | BY OWNER            |                            |
| 6  | GRAB BAR                 | TOP # 3'-0" A.F.F.  | 36" LONG                   |
| 7  | GRAB BAR                 | TOP # 3'-0" A.F.F.  | 42" LONG                   |
| 8  | MIRROR                   | BY OWNER            |                            |
| 9  | DIVIDER WALL             | PER MFG             | SURFACE MOUNTED COLOR TBD  |
| 10 | BABY CHANGING TABLE      | PER MFG             | SURFACE MOUNTED            |

#### BUILDING AREA:

|                   |                      |
|-------------------|----------------------|
| FIRST FLOOR AREA  | 5,250 SQ. FT.        |
| PATIO AREA        | 860 SQ. FT.          |
| MEZZANINE         | 613 SQ. FT.          |
| <b>TOTAL AREA</b> | <b>6,723 SQ. FT.</b> |

#### SEATING:

|                    |            |
|--------------------|------------|
| DINING             | 187        |
| PATIO              | 38         |
| <b>TOTAL SEATS</b> | <b>225</b> |

(P) 713.680.1333  
(F) 713.680.1334

3301 Edloe Suite 100  
Houston TX 77027

gene giles  
commercial • residential • planning



DO NOT SCALE DRAWINGS  
CONTRACTOR TO VERIFY ALL  
EXISTING CONDITIONS AND  
DIMENSIONS-NOTIFY DESIGNER  
OF ANY DISCREPANCIES PRIOR  
TO BEGINNING CONSTRUCTION.

| VERSION ID    | DATE     |
|---------------|----------|
| PERMIT REVIEW | 09/21/10 |

PROJECT NUMBER  
**FC5625**  
SCALE  
**AS NOTED**  
SHEET ID  
FIRST FLOOR PLAN  
SHEET NUMBER

**A100**

ISSUE DATE - 5-26-2010  
PRINT DATE - 9-21-2010

THIS PLAN IS COPYRIGHT PROTECTED AND THE SOLE  
PROPERTY OF GENE GILES. ANY UNAUTHORIZED  
COPIES OR DISTRIBUTION IS A VIOLATION OF  
FEDERAL COPYRIGHT LAW AND  
SUBJECT TO PROSECUTION UNDER THE  
SUBLEGNS OF THE FEDERAL COPYRIGHT ACT